

**HIGHLIGHTS OF PRESCRIBING INFORMATION**

These highlights do not include all the information needed to use NEULASTA safely and effectively. See [full prescribing information](#) for NEULASTA.

NEULASTA® (pegfilgrastim) injection, for subcutaneous use  
Initial U.S. Approval: 2002

-----RECENT MAJOR CHANGES-----

- Indications and Usage (1.2) 11/2015
- Dosage and Administration (2.2, 2.3) 11/2015
- Warnings and Precautions (5.6, 5.7, 5.8) 09/2015
- Dosage and Administration (2.4, 2.5) 12/2014
- Warnings and Precautions (5.4) 12/2014

-----INDICATIONS AND USAGE-----

Neulasta is a leukocyte growth factor indicated to

- Decrease the incidence of infection, as manifested by febrile neutropenia, in patients with non-myeloid malignancies receiving myelosuppressive anti-cancer drugs associated with a clinically significant incidence of febrile neutropenia. (1.1)
- Increase survival in patients acutely exposed to myelosuppressive doses of radiation (Hematopoietic Subsyndrome of Acute Radiation Syndrome). (1.2)

Neulasta is not indicated for the mobilization of peripheral blood progenitor cells for hematopoietic stem cell transplantation.

-----DOSAGE AND ADMINISTRATION-----

- Patients with cancer receiving myelosuppressive chemotherapy
  - 6 mg administered subcutaneously once per chemotherapy cycle. (2.1)
  - Do not administer between 14 days before and 24 hours after administration of cytotoxic chemotherapy. (2.1)
  - Use weight based dosing for pediatric patients weighing less than 45 kg; refer to Table 1. (2.3)
- Patients acutely exposed to myelosuppressive doses of radiation
  - Two doses, 6 mg each, administered subcutaneously one week apart. Administer the first dose as soon as possible after suspected or confirmed exposure to myelosuppressive doses of radiation, and a second dose one week after. (2.2)
  - Use weight based dosing for pediatric patients weighing less than 45 kg; refer to Table 1. (2.3)

-----DOSAGE FORMS AND STRENGTHS-----

- Injection: 6 mg/0.6 mL solution in a single use prefilled syringe for manual use only. (3)

- Injection: 6 mg/0.6 mL solution in a single prefilled syringe co-packaged with the On-body Injector for Neulasta.

-----CONTRAINDICATIONS-----

Patients with a history of serious allergic reactions to human granulocyte colony-stimulating factors such as pegfilgrastim or filgrastim. (4)

-----WARNINGS AND PRECAUTIONS-----

- Fatal splenic rupture: Evaluate patients who report left upper abdominal or shoulder pain for an enlarged spleen or splenic rupture. (5.1)
- Acute respiratory distress syndrome (ARDS): Evaluate patients who develop fever, lung infiltrates, or respiratory distress. Discontinue Neulasta in patients with ARDS. (5.2)
- Serious allergic reactions, including anaphylaxis: Permanently discontinue Neulasta in patients with serious allergic reactions. (5.3)
- The On-body Injector for Neulasta uses acrylic adhesive. For patients who have reactions to acrylic adhesives, use of this product may result in a significant reaction (5.4)
- Fatal sickle cell crises: Have occurred. (5.5)
- Glomerulonephritis: Evaluate and consider dose-reduction or interruption of Neulasta if causality is likely. (5.6)

-----ADVERSE REACTIONS-----

Most common adverse reactions (≥ 5% difference in incidence compared to placebo) are bone pain and pain in extremity. (6.1)

To report SUSPECTED ADVERSE REACTIONS, contact Amgen Inc. at 1-800-77-AMGEN (1-800-772-6436) or FDA at 1-800-FDA-1088 or [www.fda.gov/medwatch](http://www.fda.gov/medwatch).

-----USE IN SPECIFIC POPULATIONS-----

- Pregnancy: Based on animal data, may cause fetal harm. (8.1)
- Nursing Mothers: Caution should be exercised when administered to a nursing woman. (8.3)

See 17 for PATIENT COUNSELING INFORMATION and FDA-approved patient labeling

Revised: 11/2015

**FULL PRESCRIBING INFORMATION: CONTENTS\***

**1 INDICATIONS AND USAGE**

- 1.1 Patients with Cancer Receiving Myelosuppressive Chemotherapy
- 1.2 Patients with Hematopoietic Subsyndrome of Acute Radiation Syndrome

**2 DOSAGE AND ADMINISTRATION**

- 2.1 Patients with Cancer Receiving Myelosuppressive Chemotherapy
- 2.2 Patients with Hematopoietic Subsyndrome of Acute Radiation Syndrome
- 2.3 Administration
- 2.4 Special Healthcare Provider Instructions for the On-body Injector for Neulasta
- 2.5 Advice to Give to Patients Regarding Administration via the On-body Injector for Neulasta

**3 DOSAGE FORMS AND STRENGTHS**

**4 CONTRAINDICATIONS**

**5 WARNINGS AND PRECAUTIONS**

- 5.1 Splenic Rupture
- 5.2 Acute Respiratory Distress Syndrome
- 5.3 Serious Allergic Reactions
- 5.4 Allergies to Acrylics
- 5.5 Use in Patients with Sickle Cell Disorders
- 5.6 Glomerulonephritis
- 5.7 Leukocytosis
- 5.8 Capillary Leak Syndrome
- 5.9 Potential for Tumor Growth Stimulatory Effects on Malignant Cells

**6 ADVERSE REACTIONS**

- 6.1 Clinical Trials Experience
- 6.2 Immunogenicity
- 6.3 Postmarketing Experience

**7 DRUG INTERACTIONS**

**8 USE IN SPECIFIC POPULATIONS**

- 8.1 Pregnancy
- 8.3 Nursing Mothers
- 8.4 Pediatric Use
- 8.5 Geriatric Use
- 8.6 Renal Impairment

**10 OVERDOSAGE**

**11 DESCRIPTION**

**12 CLINICAL PHARMACOLOGY**

- 12.1 Mechanism of Action
- 12.2 Pharmacodynamics
- 12.3 Pharmacokinetics

**13 NONCLINICAL TOXICOLOGY**

- 13.1 Carcinogenesis, Mutagenesis, Impairment of Fertility
- 13.3 Reproductive and Developmental Toxicology

**14 CLINICAL STUDIES**

- 14.1 Patients with Cancer Receiving Myelosuppressive Chemotherapy
- 14.2 Patients with Hematopoietic Syndrome of Acute Radiation Syndrome

**16 HOW SUPPLIED/STORAGE AND HANDLING**

**17 PATIENT COUNSELING INFORMATION**

\*Sections or subsections omitted from the full prescribing information are not listed.

---

## FULL PRESCRIBING INFORMATION

### 1 INDICATIONS AND USAGE

#### 1.1 Patients with Cancer Receiving Myelosuppressive Chemotherapy

Neulasta is indicated to decrease the incidence of infection, as manifested by febrile neutropenia, in patients with non-myeloid malignancies receiving myelosuppressive anti-cancer drugs associated with a clinically significant incidence of febrile neutropenia [see *Clinical Studies (14.1)*].

Neulasta is not indicated for the mobilization of peripheral blood progenitor cells for hematopoietic stem cell transplantation.

#### 1.2 Patients with Hematopoietic Subsyndrome of Acute Radiation Syndrome

Neulasta is indicated to increase survival in patients acutely exposed to myelosuppressive doses of radiation [see *Dosage and Administration (2.2)* and *Clinical Studies (14.2)*].

### 2 DOSAGE AND ADMINISTRATION

#### 2.1 Patients with Cancer Receiving Myelosuppressive Chemotherapy

The recommended dosage of Neulasta is a single subcutaneous injection of 6 mg administered once per chemotherapy cycle. For dosing in pediatric patients weighing less than 45 kg, refer to Table 1. Do not administer Neulasta between 14 days before and 24 hours after administration of cytotoxic chemotherapy.

#### 2.2 Patients with Hematopoietic Subsyndrome of Acute Radiation Syndrome

The recommended dose of Neulasta is two doses, 6 mg each, administered subcutaneously one week apart. For dosing in pediatric patients weighing less than 45 kg, refer to Table 1. Administer the first dose as soon as possible after suspected or confirmed exposure to radiation levels greater than 2 gray (Gy). Administer the second dose one week after the first dose.

Obtain a baseline complete blood count (CBC). Do not delay administration of Neulasta if a CBC is not readily available. Estimate a patient's absorbed radiation dose (i.e., level of radiation exposure) based on information from public health authorities, biodosimetry if available, or clinical findings such as time to onset of vomiting or lymphocyte depletion kinetics.

#### 2.3 Administration

Neulasta is administered subcutaneously via a single prefilled syringe for manual use or for use with the On-body Injector for Neulasta which is co-packaged with a single prefilled syringe. Use of the On-body Injector for Neulasta has not been studied in pediatric patients.

##### *Pediatric Patients weighing less than 45 kg*

The Neulasta prefilled syringe is not designed to allow for direct administration of doses less than 0.6 mL (6 mg). The syringe does not bear graduation marks which are necessary to accurately measure doses of Neulasta less than 0.6 mL (6 mg) for direct administration to patients. Thus, the direct administration to patients requiring dosing of less than 0.6 mL (6 mg) is not recommended due to the potential for dosing errors. Refer to Table 1.

#### **Table 1. Dosing of Neulasta for pediatric patients weighing less than 45 kg**

Body Weight	Neulasta Dose	Volume to Administer
Less than 10 kg*	See below*	See below*
10 - 20 kg	1.5 mg	0.15 mL
21 - 30 kg	2.5 mg	0.25 mL
31 - 44 kg	4 mg	0.40 mL

\*For pediatric patients weighing less than 10 kg, administer 0.1 mg/kg (0.01 mL/kg) of Neulasta.

Visually inspect parenteral drug products (prefilled syringe) for particulate matter and discoloration prior to administration, whenever solution and container permit. Do not administer Neulasta if discoloration or particulates are observed.

The needle cap on the prefilled syringes contains dry natural rubber (derived from latex); persons with latex allergies should not administer these products.

#### **2.4 Special Healthcare Provider Instructions for the On-body Injector for Neulasta**

A healthcare provider must fill the On-body Injector with Neulasta using the prefilled syringe and then apply the On-body Injector for Neulasta to the patient's skin (abdomen or back of arm). The back of the arm may only be used if there is a caregiver available to monitor the status of the On-body Injector for Neulasta. Approximately 27 hours after the On-body Injector for Neulasta is applied to the patient's skin, Neulasta will be delivered over approximately 45 minutes. A healthcare provider may initiate administration with the On-body Injector for Neulasta on the same day as the administration of cytotoxic chemotherapy, as long as the On-body Injector for Neulasta delivers Neulasta no less than 24 hours after administration of cytotoxic chemotherapy.

The prefilled syringe co-packaged in Neulasta Onpro™ kit must only be used with the On-body Injector for Neulasta. The prefilled syringe contains additional solution to compensate for liquid loss during delivery through the On-body Injector for Neulasta. If the prefilled syringe co-packaged in Neulasta Onpro kit is used for manual subcutaneous injection, the patient will receive an overdose. If the single use prefilled syringe for manual use is used with the On-body Injector for Neulasta, the patient may receive less than the recommended dose.

Do not use the On-body Injector for Neulasta to deliver any other drug product except the Neulasta prefilled syringe co-packaged with the On-body Injector for Neulasta.

The On-body Injector for Neulasta should be applied to intact, non-irritated skin on the arm or abdomen.

A missed dose could occur due to an On-body Injector for Neulasta failure or leakage. If the patient misses a dose, a new dose should be administered by single prefilled syringe for manual use, as soon as possible after detection.

Refer to the Healthcare Provider Instructions for Use for the On-body Injector for Neulasta for full administration information.

#### **2.5 Advice to Give to Patients Regarding Administration via the On-body Injector for Neulasta**

Advise patients to avoid activities such as traveling, driving, or operating heavy machinery during hours 26-29 following application of the On-body Injector for Neulasta (this includes the 45-minute delivery period plus an hour post-delivery). Patients should have a caregiver nearby for the first use.

Refer the patient to the dose delivery information written on the Patient Instructions for Use. Provide training to patients to ensure they understand when the dose delivery of Neulasta will begin and how to monitor the On-body Injector for Neulasta for completed delivery. Ensure patients understand how to identify signs of malfunction of On-body Injector for Neulasta— [see *Warnings and Precautions (5.3) and Patient Counseling Information (17)*].

### **3 DOSAGE FORMS AND STRENGTHS**

- Injection: 6 mg/0.6 mL solution in a single-use prefilled syringe for manual use only.
- Injection: 6 mg/0.6 mL solution in a single-use prefilled syringe co-packaged with the On-body Injector for Neulasta (Neulasta Onpro kit).

### **4 CONTRAINDICATIONS**

Do not administer Neulasta to patients with a history of serious allergic reactions to pegfilgrastim or filgrastim.

### **5 WARNINGS AND PRECAUTIONS**

#### **5.1 Splenic Rupture**

Splenic rupture, including fatal cases, can occur following the administration of Neulasta. Evaluate for an enlarged spleen or splenic rupture in patients who report left upper abdominal or shoulder pain after receiving Neulasta.

#### **5.2 Acute Respiratory Distress Syndrome**

Acute respiratory distress syndrome (ARDS) can occur in patients receiving Neulasta. Evaluate patients who develop fever and lung infiltrates or respiratory distress after receiving Neulasta, for ARDS. Discontinue Neulasta in patients with ARDS.

#### **5.3 Serious Allergic Reactions**

Serious allergic reactions, including anaphylaxis, can occur in patients receiving Neulasta. The majority of reported events occurred upon initial exposure. Allergic reactions, including anaphylaxis, can recur within days after the discontinuation of initial anti-allergic treatment. Permanently discontinue Neulasta in patients with serious allergic reactions. Do not administer Neulasta to patients with a history of serious allergic reactions to pegfilgrastim or filgrastim.

#### **5.4 Allergies to Acrylics**

The On-body Injector for Neulasta uses acrylic adhesive. For patients who have reactions to acrylic adhesives, use of this product may result in a significant reaction.

#### **5.5 Use in Patients with Sickle Cell Disorders**

Severe sickle cell crises can occur in patients with sickle cell disorders receiving Neulasta. Severe and sometimes fatal sickle cell crises can occur in patients with sickle cell disorders receiving filgrastim, the parent compound of pegfilgrastim.

#### **5.6 Glomerulonephritis**

Glomerulonephritis has occurred in patients receiving Neulasta. The diagnoses were based upon azotemia, hematuria (microscopic and macroscopic), proteinuria, and renal biopsy. Generally, events of glomerulonephritis

resolved after dose reduction or discontinuation of Neulasta. If glomerulonephritis is suspected, evaluate for cause. If causality is likely, consider dose-reduction or interruption of Neulasta.

### 5.7 Leukocytosis

White blood cell (WBC) counts of  $100 \times 10^9/L$  or greater have been observed in patients receiving pegfilgrastim. Monitoring of complete blood count (CBC) during pegfilgrastim therapy is recommended.

### 5.8 Capillary Leak Syndrome

Capillary leak syndrome has been reported after G-CSF administration, including Neulasta, and is characterized by hypotension, hypoalbuminemia, edema and hemoconcentration. Episodes vary in frequency, severity and may be life-threatening if treatment is delayed. Patients who develop symptoms of capillary leak syndrome should be closely monitored and receive standard symptomatic treatment, which may include a need for intensive care.

### 5.9 Potential for Tumor Growth Stimulatory Effects on Malignant Cells

The granulocyte-colony stimulating factor (G-CSF) receptor through which pegfilgrastim and filgrastim act has been found on tumor cell lines. The possibility that pegfilgrastim acts as a growth factor for any tumor type, including myeloid malignancies and myelodysplasia, diseases for which pegfilgrastim is not approved, cannot be excluded.

## 6 ADVERSE REACTIONS

The following serious adverse reactions are discussed in greater detail in other sections of the labeling:

- Splenic Rupture [*See Warnings and Precautions (5.1)*]
- Acute Respiratory Distress Syndrome [*See Warnings and Precautions (5.2)*]
- Serious Allergic Reactions [*See Warnings and Precautions (5.3)*]
- Allergies to Acrylics [*See Warnings and Precautions (5.4)*]
- Use in Patients with Sickle Cell Disorders [*See Warnings and Precautions (5.5)*]
- Glomerulonephritis [*See Warnings and Precautions (5.6)*]
- Leukocytosis [*See Warnings and Precautions (5.7)*]
- Capillary Leak Syndrome [*See Warnings and Precautions (5.8)*]
- Potential for Tumor Growth Stimulatory Effects on Malignant Cells [*See Warnings and Precautions (5.9)*]

### 6.1 Clinical Trials Experience

Because clinical trials are conducted under widely varying conditions, adverse reaction rates observed in the clinical trials of a drug cannot be directly compared with rates in the clinical trials of another drug and may not reflect the rates observed in clinical practice.

Neulasta clinical trials safety data are based upon 932 patients receiving Neulasta in seven randomized clinical trials. The population was 21 to 88 years of age and 92% female. The ethnicity was 75% Caucasian, 18% Hispanic, 5% Black, and 1% Asian. Patients with breast (n = 823), lung and thoracic tumors (n = 53) and lymphoma (n = 56) received Neulasta after nonmyeloablative cytotoxic chemotherapy. Most patients received a single 100 mcg/kg (n = 259) or a single 6 mg (n = 546) dose per chemotherapy cycle over 4 cycles.

The following adverse reaction data in Table 2 are from a randomized, double-blind, placebo-controlled study in patients with metastatic or non-metastatic breast cancer receiving docetaxel 100 mg/m<sup>2</sup> every 21 days (Study 3). A total of 928 patients were randomized to receive either 6 mg Neulasta (n = 467) or placebo (n = 461). The patients

were 21 to 88 years of age and 99% female. The ethnicity was 66% Caucasian, 31% Hispanic, 2% Black, and <1% Asian, Native American or other.

The most common adverse reactions occurring in  $\geq 5\%$  of patients and with a between-group difference of  $\geq 5\%$  higher in the pegfilgrastim arm in placebo controlled clinical trials are bone pain and pain in extremity.

**Table 2. Adverse Reactions with  $\geq 5\%$  Higher Incidence in Neulasta Patients Compared to Placebo in (Study 3)**

System Organ Class Preferred Term	Placebo (N= 461)	Neulasta 6 mg SC on Day 2 (N= 467)
Musculoskeletal and connective tissue disorders		
Bone pain	26%	31%
Pain in extremity	4%	9%

#### *Leukocytosis*

In clinical studies, leukocytosis (WBC counts  $> 100 \times 10^9/L$ ) was observed in less than 1% of 932 patients with non-myeloid malignancies receiving Neulasta. No complications attributable to leukocytosis were reported in clinical studies.

## 6.2 Immunogenicity

As with all therapeutic proteins, there is a potential for immunogenicity. Binding antibodies to pegfilgrastim were detected using a BIAcore assay. The approximate limit of detection for this assay is 500 ng/mL. Pre-existing binding antibodies were detected in approximately 6% (51/849) of patients with metastatic breast cancer. Four of 521 pegfilgrastim-treated subjects who were negative at baseline developed binding antibodies to pegfilgrastim following treatment. None of these 4 patients had evidence of neutralizing antibodies detected using a cell-based bioassay.

The detection of antibody formation is highly dependent on the sensitivity and specificity of the assay, and the observed incidence of antibody positivity in an assay may be influenced by several factors, including assay methodology, sample handling, timing of sample collection, concomitant medications, and underlying disease. For these reasons, comparison of the incidence of antibodies to Neulasta with the incidence of antibodies to other products may be misleading.

## 6.3 Postmarketing Experience

The following adverse reactions have been identified during post approval use of Neulasta. Because these reactions are reported voluntarily from a population of uncertain size, it is not always possible to reliably estimate their frequency or establish a causal relationship to drug exposure.

- Splenic rupture and splenomegaly (enlarged spleen) [see Warnings and Precautions (5.1)]
- Acute respiratory distress syndrome (ARDS) [see Warnings and Precautions (5.2)]
- Allergic reactions/hypersensitivity, including anaphylaxis, skin rash, and urticaria, generalized erythema and flushing [see Warnings and Precautions (5.3)]
- Sick cell crisis [see Warnings and Precautions (5.5)]
- Glomerulonephritis [see Warnings and Precautions (5.6)]
- Leukocytosis [see Warnings and Precautions (5.7)]

- Capillary leak syndrome [see Warnings and Precautions (5.8)]
- Injection site reactions
- Sweet's syndrome, (acute febrile neutrophilic dermatosis), cutaneous vasculitis

## 7 DRUG INTERACTIONS

No formal drug interaction studies between Neulasta and other drugs have been performed. Increased hematopoietic activity of the bone marrow in response to growth factor therapy may result in transiently positive bone-imaging changes. Consider these findings when interpreting bone-imaging results.

## 8 USE IN SPECIFIC POPULATIONS

### 8.1 Pregnancy

#### Pregnancy Category C

There are no adequate and well-controlled studies in pregnant women. Pegfilgrastim was embryotoxic and increased pregnancy loss in pregnant rabbits that received cumulative doses approximately 4 times the recommended human dose (based on body surface area). Signs of maternal toxicity occurred at these doses. Neulasta should be used during pregnancy only if the potential benefit to the mother justifies the potential risk to the fetus.

In animal reproduction studies, when pregnant rabbits received pegfilgrastim at cumulative doses approximately 4 times the recommended human dose (based on body surface area), increased embryoletality and spontaneous abortions occurred. Signs of maternal toxicity (reductions in body weight gain/food consumption) and decreased fetal weights occurred at maternal doses approximately equivalent to the recommended human dose (based on body surface area). There were no structural anomalies observed in rabbit offspring at any dose tested. No evidence of reproductive/developmental toxicity occurred in the offspring of pregnant rats that received cumulative doses of pegfilgrastim approximately 10 times the recommended human dose (based on body surface area) [see *Nonclinical Toxicology* (13.3)].

### 8.3 Nursing Mothers

It is not known whether pegfilgrastim is secreted in human milk. Other recombinant G-CSF products are poorly secreted in breast milk and G-CSF is not orally absorbed by neonates. Caution should be exercised when administered to a nursing woman.

### 8.4 Pediatric Use

The safety and effectiveness of Neulasta have been established in pediatric patients. No overall differences in safety were identified between adult and pediatric patients based on postmarketing surveillance and review of the scientific literature.

Use of Neulasta in pediatric patients for chemotherapy-induced neutropenia is based on adequate and well controlled studies in adults with additional pharmacokinetic and safety data in pediatric patients with sarcoma [see *Clinical Pharmacology* (12.3) and *Clinical Studies* (14.1)].

The use of Neulasta to increase survival in pediatric patients acutely exposed to myelosuppressive doses of radiation is based on efficacy studies conducted in animals and clinical data supporting the use of Neulasta in patients with cancer receiving myelosuppressive chemotherapy. Efficacy studies of Neulasta could not be conducted in humans with acute radiation syndrome for ethical and feasibility reasons. Results from population modeling and simulation indicate that two doses of Neulasta (Table 1), administered one week apart provide pediatric patients with exposures comparable to that in adults receiving two 6 mg doses one week apart [see *Dosage and Administration* (2.3), *Clinical Pharmacology* (12.3) and *Clinical Studies* (14.2)].



## 8.5 Geriatric Use

Of the 932 patients with cancer who received Neulasta in clinical studies, 139 (15%) were aged 65 and over, and 18 (2%) were aged 75 and over. No overall differences in safety or effectiveness were observed between patients aged 65 and older and younger patients.

## 8.6 Renal Impairment

Renal dysfunction had no effect on the pharmacokinetics of pegfilgrastim. Therefore, pegfilgrastim dose adjustment in patients with renal dysfunction is not necessary [see *Clinical Pharmacology (12.3)*].

## 10 OVERDOSAGE

The maximum amount of Neulasta that can be safely administered in single or multiple doses has not been determined. Single subcutaneous doses of 300 mcg/kg have been administered to 8 healthy volunteers and 3 patients with non-small cell lung cancer without serious adverse effects. These patients experienced a mean maximum absolute neutrophil count (ANC) of  $55 \times 10^9/L$ , with a corresponding mean maximum WBC of  $67 \times 10^9/L$ . The absolute maximum ANC observed was  $96 \times 10^9/L$  with a corresponding absolute maximum WBC observed of  $120 \times 10^9/L$ . The duration of leukocytosis ranged from 6 to 13 days. The effectiveness of leukapheresis in the management of symptomatic individuals with Neulasta-induced leukocytosis has not been studied.

## 11 DESCRIPTION

Neulasta (pegfilgrastim) is a covalent conjugate of recombinant methionyl human G-CSF (filgrastim) and monomethoxypolyethylene glycol. Filgrastim is a water-soluble 175 amino acid protein with a molecular weight of approximately 19 kilodaltons (kD). Filgrastim is obtained from the bacterial fermentation of a strain of *E coli* transformed with a genetically engineered plasmid containing the human G-CSF gene. To produce pegfilgrastim, a 20 kD monomethoxypolyethylene glycol molecule is covalently bound to the N-terminal methionyl residue of filgrastim. The average molecular weight of pegfilgrastim is approximately 39 kD.

Neulasta is provided in two presentations:

- Neulasta for manual subcutaneous injection is supplied in 0.6 mL prefilled syringes. The prefilled syringe does not bear graduation marks and is designed to deliver the entire contents of the syringe (6 mg/0.6 mL).
- On-body Injector for Neulasta is supplied with a prefilled syringe containing 0.64 mL of Neulasta in solution that delivers 0.6 mL of Neulasta in solution when used with the On-body Injector for Neulasta. The syringe does not bear graduation marks and is only to be used with the On-body Injector for Neulasta.

The delivered 0.6 mL dose from either the prefilled syringe for manual subcutaneous injection or the On-body Injector for Neulasta contains 6 mg pegfilgrastim (based on protein weight) in a sterile, clear, colorless, preservative-free solution (pH 4.0) containing acetate (0.35 mg), polysorbate 20 (0.02 mg), sodium (0.02 mg), and sorbitol (30 mg) in Water for Injection, USP.

## 12 CLINICAL PHARMACOLOGY

### 12.1 Mechanism of Action

Pegfilgrastim is a colony-stimulating factor that acts on hematopoietic cells by binding to specific cell surface receptors, thereby stimulating proliferation, differentiation, commitment, and end cell functional activation.

### 12.2 Pharmacodynamics

Animal data and clinical data in humans suggest a correlation between pegfilgrastim exposure and the duration of severe neutropenia as a predictor of efficacy. Selection of the dosing regimen of Neulasta is based on reducing the duration of severe neutropenia.

### 12.3 Pharmacokinetics

The pharmacokinetics of pegfilgrastim was studied in 379 patients with cancer. The pharmacokinetics of pegfilgrastim was nonlinear and clearance decreased with increases in dose. Neutrophil receptor binding is an important component of the clearance of pegfilgrastim, and serum clearance is directly related to the number of neutrophils. In addition to numbers of neutrophils, body weight appeared to be a factor. Patients with higher body weights experienced higher systemic exposure to pegfilgrastim after receiving a dose normalized for body weight. A large variability in the pharmacokinetics of pegfilgrastim was observed. The half-life of Neulasta ranged from 15 to 80 hours after subcutaneous injection. In healthy volunteers, the pharmacokinetics of pegfilgrastim were comparable when delivered subcutaneously via a manual prefilled syringe versus via the On-body Injector for Neulasta.

#### *Specific Populations*

No gender-related differences were observed in the pharmacokinetics of pegfilgrastim, and no differences were observed in the pharmacokinetics of geriatric patients ( $\geq 65$  years of age) compared with younger patients ( $< 65$  years of age) [see *Use in Specific Populations (8.5)*].

#### Renal Impairment

In a study of 30 subjects with varying degrees of renal dysfunction, including end stage renal disease, renal dysfunction had no effect on the pharmacokinetics of pegfilgrastim [see *Use in Specific Populations (8.6)*].

#### Pediatric Patients with Cancer Receiving Myelosuppressive Chemotherapy

The pharmacokinetics and safety of pegfilgrastim were studied in 37 pediatric patients with sarcoma in Study 4 [see *Clinical Studies 14.1*]. The mean ( $\pm$  standard deviation [SD]) systemic exposure ( $AUC_{0-\infty}$ ) of Neulasta after subcutaneous administration at 100 mcg/kg was 47.9 ( $\pm 22.5$ ) mcg·hr/mL in the youngest age group (0 to 5 years,  $n = 11$ ), 22.0 ( $\pm 13.1$ ) mcg·hr/mL in the (6 to 11 years age group ( $n = 10$ ), and 29.3 ( $\pm 23.2$ ) mcg·hr/mL in the 12 to 21 years age group ( $n = 13$ ). The terminal elimination half-lives of the corresponding age groups were 30.1 ( $\pm 38.2$ ) hours, 20.2 ( $\pm 11.3$ ) hours, and 21.2 ( $\pm 16.0$ ) hours, respectively.

#### Patients Acutely Exposed to Myelosuppressive Doses of Radiation

The pharmacokinetics of pegfilgrastim is not available in patients acutely exposed to myelosuppressive doses of radiation. Based on limited pharmacokinetic data in irradiated non-human primates, the area under the concentration-time curve (AUC), reflecting the exposure to pegfilgrastim in non-human primates following a 300 mcg/kg dose of Neulasta, appears to be greater than in humans receiving a 6 mg dose. Results from population modeling and simulation indicate that two 6 mg doses of Neulasta administered one week apart in adults result in clinically relevant effects on duration of grade 3 and 4 neutropenia. In addition, weight based dosing in pediatric patients weighing less than 45 kg [see *Dosing and Administration, Section 2.3, Table 1*] provides exposures comparable to those in adults receiving two 6 mg doses one week apart.

## 13 NONCLINICAL TOXICOLOGY

### 13.1 Carcinogenesis, Mutagenesis, Impairment of Fertility

No carcinogenicity or mutagenesis studies have been performed with pegfilgrastim.

Pegfilgrastim did not affect reproductive performance or fertility in male or female rats at cumulative weekly doses approximately 6 to 9 times higher than the recommended human dose (based on body surface area).

### 13.3 Reproductive and Developmental Toxicology

Pregnant rabbits were dosed with pegfilgrastim subcutaneously every other day during the period of organogenesis. At cumulative doses ranging from the approximate human dose to approximately 4 times the recommended human dose (based on body surface area), treated rabbits exhibited decreased maternal food consumption, maternal weight loss, as well as reduced fetal body weights and delayed ossification of the fetal skull; however, no structural anomalies were observed in the offspring from either study. Increased incidences of post-implantation losses and spontaneous abortions (more than half the pregnancies) were observed at cumulative doses approximately 4 times the recommended human dose, which were not seen when pregnant rabbits were exposed to the recommended human dose.

Three studies were conducted in pregnant rats dosed with pegfilgrastim at cumulative doses up to approximately 10 times the recommended human dose at the following stages of gestation: during the period of organogenesis, from mating through the first half of pregnancy, and from the first trimester through delivery and lactation. No evidence of fetal loss or structural malformations was observed in any study. Cumulative doses equivalent to approximately 3 and 10 times the recommended human dose resulted in transient evidence of wavy ribs in fetuses of treated mothers (detected at the end of gestation but no longer present in pups evaluated at the end of lactation).

## 14 CLINICAL STUDIES

### 14.1 Patients with Cancer Receiving Myelosuppressive Chemotherapy

Neulasta was evaluated in three randomized, double-blind, controlled studies. Studies 1 and 2 were active-controlled studies that employed doxorubicin 60 mg/m<sup>2</sup> and docetaxel 75 mg/m<sup>2</sup> administered every 21 days for up to 4 cycles for the treatment of metastatic breast cancer. Study 1 investigated the utility of a fixed dose of Neulasta. Study 2 employed a weight-adjusted dose. In the absence of growth factor support, similar chemotherapy regimens have been reported to result in a 100% incidence of severe neutropenia (ANC < 0.5 x 10<sup>9</sup>/L) with a mean duration of 5 to 7 days and a 30% to 40% incidence of febrile neutropenia. Based on the correlation between the duration of severe neutropenia and the incidence of febrile neutropenia found in studies with filgrastim, duration of severe neutropenia was chosen as the primary endpoint in both studies, and the efficacy of Neulasta was demonstrated by establishing comparability to filgrastim-treated patients in the mean days of severe neutropenia.

In Study 1, 157 patients were randomized to receive a single subcutaneous injection of Neulasta (6 mg) on day 2 of each chemotherapy cycle or daily subcutaneous filgrastim (5 mcg/kg/day) beginning on day 2 of each chemotherapy cycle. In Study 2, 310 patients were randomized to receive a single subcutaneous injection of Neulasta (100 mcg/kg) on day 2 or daily subcutaneous filgrastim (5 mcg/kg/day) beginning on day 2 of each chemotherapy cycle.

Both studies met the major efficacy outcome measure of demonstrating that the mean days of severe neutropenia of Neulasta-treated patients did not exceed that of filgrastim-treated patients by more than 1 day in cycle 1 of chemotherapy. The mean days of cycle 1 severe neutropenia in Study 1 were 1.8 days in the Neulasta arm compared to 1.6 days in the filgrastim arm [difference in means 0.2 (95% CI -0.2, 0.6)] and in Study 2 were 1.7 days in the Neulasta arm compared to 1.6 days in the Filgrastim arm [difference in means 0.1 (95% CI -0.2, 0.4)].

A secondary endpoint in both studies was days of severe neutropenia in cycles 2 through 4 with results similar to those for cycle 1.

Study 3 was a randomized, double-blind, placebo-controlled study that employed docetaxel 100 mg/m<sup>2</sup> administered every 21 days for up to 4 cycles for the treatment of metastatic or non-metastatic breast cancer. In this study, 928 patients were randomized to receive a single subcutaneous injection of Neulasta (6 mg) or placebo on day 2 of each chemotherapy cycle. Study 3 met the major trial outcome measure of demonstrating that the incidence of febrile neutropenia (defined as temperature ≥ 38.2°C and ANC ≤ 0.5 x 10<sup>9</sup>/L) was lower for Neulasta-treated patients as compared to placebo-treated patients (1% versus 17%, respectively, p < 0.001). The incidence of hospitalizations

(1% versus 14%) and IV anti-infective use (2% versus 10%) for the treatment of febrile neutropenia was also lower in the Neulasta-treated patients compared to the placebo-treated patients.

Study 4 was a multicenter, randomized, open-label study to evaluate the efficacy, safety, and pharmacokinetics [see *Clinical Pharmacology (12.3)*] of Neulasta in pediatric and young adult patients with sarcoma. Patients with sarcoma receiving chemotherapy age 0 to 21 years were eligible. Patients were randomized to receive subcutaneous Neulasta as a single dose of 100 mcg/kg (n= 37) or subcutaneous filgrastim at a dose 5 mcg/kg/day (n=6) following myelosuppressive chemotherapy. Recovery of neutrophil counts was similar in the Neulasta and filgrastim groups. The most common adverse reaction reported was bone pain.

## 14.2 Patients with Hematopoietic Subsyndrome of Acute Radiation Syndrome

Efficacy studies of Neulasta could not be conducted in humans with acute radiation syndrome for ethical and feasibility reasons. Approval of this indication was based on efficacy studies conducted in animals and data supporting Neulasta's effect on severe neutropenia in patients with cancer receiving myelosuppressive chemotherapy [see *Dosage and Administration (2.1)*].

The recommended dose of Neulasta is two doses, 6 mg each, administered one week apart for humans exposed to myelosuppressive doses of radiation. For pediatric patients those weighing less than 45 kg, dosing of Neulasta is weight based and is provided in Table 1 [see *Dosage and Administration (2.3)*]. This dosing regimen is based on population modeling and simulation analyses. The exposure associated with this dosing regimen is expected to provide sufficient pharmacodynamic activity to treat humans exposed to myelosuppressive doses of radiation [see *Clinical Pharmacology (12.3)*]. The safety of Neulasta at a dose of 6 mg has been assessed on the basis of clinical experience in patients with cancer receiving myelosuppressive chemotherapy.

The efficacy of Neulasta for the acute radiation syndrome setting was studied in a randomized, placebo-controlled non-human primate model of radiation injury. Rhesus macaques were randomized to either a control (n=23) or treated (n=23) cohort. On study day 0, animals (n = 6 to 8 per irradiation day) were exposed to total body irradiation (TBI) of  $7.50 \pm 0.15$  Gy delivered at  $0.8 \pm 0.03$  Gy/min, representing a dose that would be lethal in 50% of animals by 60 days of follow-up (LD50/60). Animals were administered subcutaneous injections of a blinded treatment (control article [5% dextrose in water] or pegfilgrastim [300-319 mcg/kg/day]) on study day 1 and on study day 8. The primary endpoint was survival. Animals received medical management consisting of intravenous fluids, antibiotics, blood transfusions, and other support as required.

Pegfilgrastim significantly (at 0.0014 level of significance) increased 60-day survival in irradiated non-human primates: 91% survival (21/23) in the pegfilgrastim group compared to 48% survival (11/23) in the control group.

## 16 HOW SUPPLIED/STORAGE AND HANDLING

### Neulasta single use prefilled syringe for manual use

Neulasta is supplied in a prefilled single use syringe for manual use containing 6 mg pegfilgrastim, supplied with a 27-gauge, 1/2-inch needle with an UltraSafe<sup>®</sup> Needle Guard.

The needle cap of the prefilled syringe contains dry natural rubber (a derivative of latex).

Neulasta is provided in a dispensing pack containing one sterile 6mg/0.6 mL prefilled syringe (NDC 55513-190-01).

Neulasta prefilled syringe does not bear graduation marks and is intended only to deliver the entire contents of the syringe (6 mg/0.6 mL) for direct administration. Use of the prefilled syringe is not recommended for direct administration for pediatric patients weighing less than 45 kg who require doses that are less than the full contents of the syringe.

Store refrigerated between 36° to 46°F (2° to 8°C) in the carton to protect from light. Do not shake. Discard syringes stored at room temperature for more than 48 hours. Avoid freezing; if frozen, thaw in the refrigerator before administration. Discard syringe if frozen more than once.

### **Neulasta Onpro™ kit**

Neulasta Onpro kit is provided in a carton containing one sterile prefilled syringe and one sterile On-body Injector for Neulasta (NDC 55513-192-01).

The single use prefilled syringe contains 0.64 mL of solution that delivers 6 mg/0.6 mL of pegfilgrastim when used with the On-body Injector for Neulasta. The prefilled syringe is supplied with a 27-gauge, 1/2-inch needle with an UltraSafe® Needle Guard. The syringe does not bear graduation marks and is only to be used with the On-body Injector for Neulasta.

The needle cap of the prefilled syringe contains dry natural rubber (a derivative of latex).

Store Neulasta Onpro kit in the refrigerator at 36°F to 46°F (2°C to 8°C) until ready for use. Because the On-body Injector for Neulasta is at room temperature during the period of use, Neulasta Onpro kit should not be held at room temperature longer than 12 hours prior to use. Discard Neulasta Onpro kit if stored at room temperature for more than 12 hours.

Do not use the On-body Injector for Neulasta if its packaging has been previously opened.

## **17 PATIENT COUNSELING INFORMATION**

Advise the patient to read the FDA-approved patient labeling (Patient Information).

Advise patients of the following risks and potential risks with Neulasta:

- Splenic rupture and splenomegaly
- Acute Respiratory Distress Syndrome
- Serious allergic reactions
- Sickle cell crisis
- Glomerulonephritis
- Capillary Leak Syndrome

Advise patients acutely exposed to myelosuppressive doses of radiation (Hematopoietic Subsyndrome of Acute Radiation Syndrome) that efficacy studies of Neulasta for this indication could not be conducted in humans for ethical and feasibility reasons and that, therefore, approval of this use was based on efficacy studies conducted in animals [*see Clinical Studies (14.2)*].

Advise patients on the use of the On-body Injector for Neulasta:

- Review the Patient Information and Patient Instructions for Use with the patient and provide the instructions to the patient.
- Refer the patient to the dose delivery information written on the Patient Instructions for Use.
- Tell the patient when their dose delivery of Neulasta will begin and when their dose delivery should be completed.
- Advise the patient that serious allergic reactions can happen with Neulasta. Patients should have a caregiver nearby for the first use. Patients should plan to be in a place where they can appropriately monitor the On-body Injector for Neulasta during the approximately 45 minute Neulasta delivery and for an

hour after the delivery. Advise the patient to avoid traveling, driving, or operating heavy machinery during hours 26-29 following application of the On-body Injector for Neulasta.

- If the On-body Injector for Neulasta is placed on the back of the arm, remind the patient that a caregiver must be available to monitor the On-body Injector for Neulasta.
- If a patient calls the healthcare provider regarding any On-body Injector for Neulasta problems, the healthcare provider is advised to call Amgen at 1-800-772-6436.
- Advise the patient:
  - to call their healthcare provider immediately if the status light on the On-body Injector for Neulasta is flashing red (see the Patient Instructions for Use).
  - to inform their healthcare provider if the adhesive on the On-body Injector for Neulasta becomes saturated with fluid, or there is dripping, as this may be evidence of significant product leakage, resulting in inadequate or missed dose (see the Patient Instructions for Use).
  - to keep the On-body Injector for Neulasta dry for approximately the last 3 hours prior to the dose delivery start to better enable potential leak detection.
  - that the On-body Injector for Neulasta should only be exposed to temperatures between 41°F and 104°F (5°C-40°C)
  - to keep the On-body Injector for Neulasta at least 4 inches away from electrical equipment such as cell phones, cordless telephones, microwaves and other common appliances. Failure to keep the On-body Injector for Neulasta at least this recommended distance may interfere with operation and can lead to a missed or incomplete dose of Neulasta.
  - that if the needle is exposed after On-body Injector for Neulasta removal, place the used On-body Injector for Neulasta in a sharps disposal container to avoid accidental needle stick and call their healthcare provider immediately.
  - to remove the On-body Injector for Neulasta after the green light shines continuously and to place the used On-body Injector for Neulasta in a sharps disposal container (see the Patient Instructions for Use).
- Advise the patient:
  - do not reapply the On-body Injector for Neulasta if the On-body Injector for Neulasta comes off before full dose is delivered and instead call their healthcare provider immediately.
  - avoid bumping the On-body Injector for Neulasta or knocking the On-body Injector for Neulasta off the body.
  - do not expose the On-body Injector for Neulasta to medical imaging studies, e.g. X-ray scan, MRI, CT scan, ultrasound and oxygen rich environments such as hyperbaric chambers to avoid On-body Injector for Neulasta damage and patient injury.
- Advise the patient to avoid:
  - airport X-ray scans and request a manual pat down instead; remind patients who elect to request a manual pat down to exercise care to avoid having the On-body Injector for Neulasta dislodged during the pat down process.
  - sleeping on the On-body Injector for Neulasta or applying pressure on the On-body Injector for Neulasta as this may affect On-body Injector for Neulasta performance.
  - getting body lotions, creams, oils and cleaning agents near the On-body Injector for Neulasta as these products may loosen the adhesive.
  - using hot tubs, whirlpools, or saunas and avoid exposing the On-body Injector for Neulasta to direct sunlight as these may affect the drug.
  - peeling off or disturbing the On-body Injector for Neulasta adhesive before delivery of full dose is complete.



Neulasta® (pegfilgrastim)

**Manufactured by:**

Amgen Inc.  
One Amgen Center Drive  
Thousand Oaks, California 91320-1799  
US License No. 1080

Patent: <http://pat.amgen.com/neulasta/>

© 2002-2015 Amgen Inc. All rights reserved.

[www.neulasta.com](http://www.neulasta.com)

1-800-77-AMGEN (1-800-772-6436)

11/2015

v1X

# Neulasta® (pegfilgrastim) Onpro™ kit Healthcare Provider Instructions for Use

## Guide to Parts

### Neulasta Prefilled Syringe with Manual Needle Guard

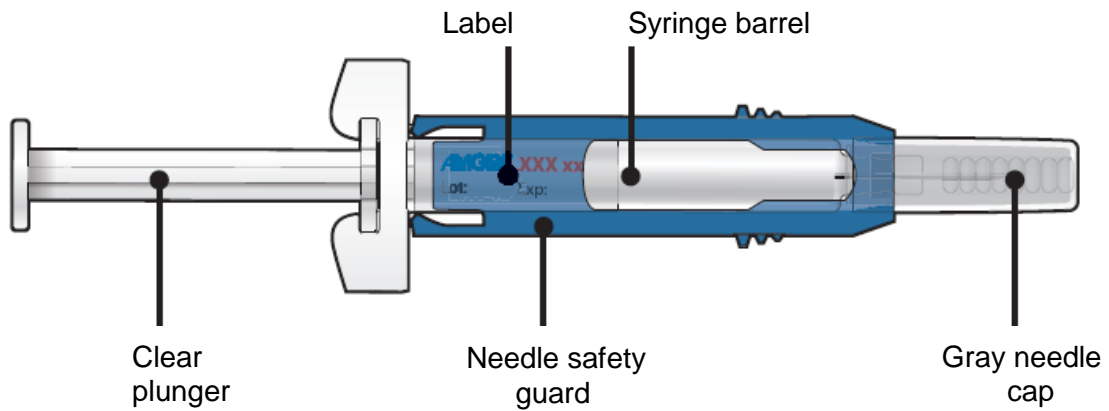

### On-body Injector for Neulasta

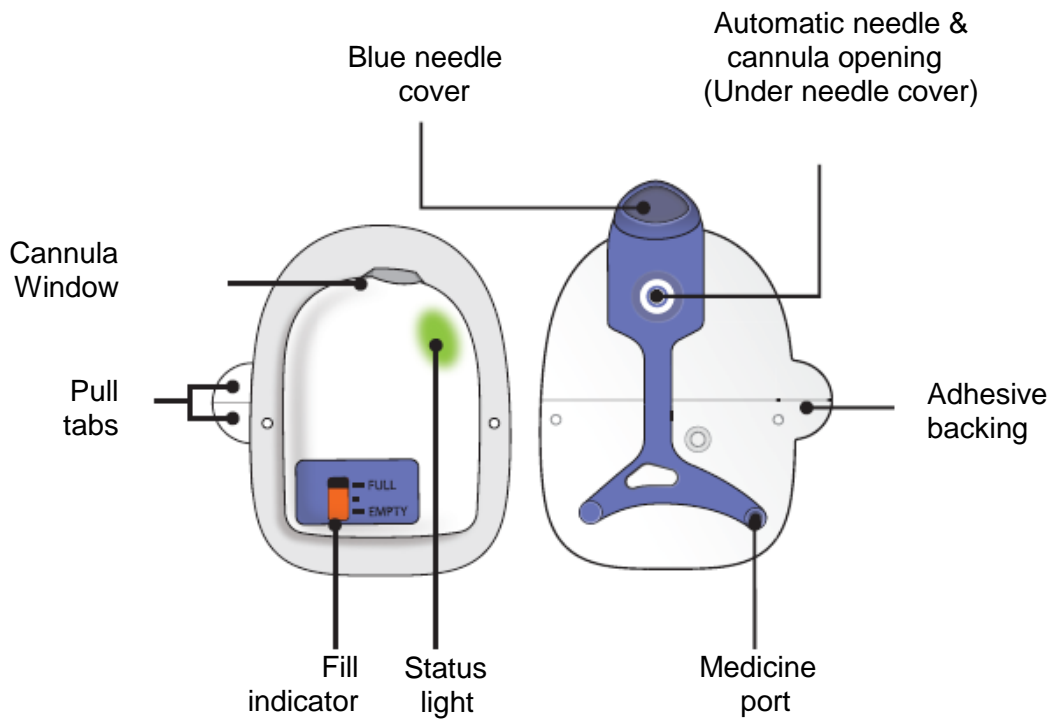



## Important

### READ THE FOLLOWING INSTRUCTIONS BEFORE USING THE ON-BODY INJECTOR

**Warning:** Do not use Neulasta Onpro kit to deliver any other drug product.

- !** See Prescribing Information for information on Neulasta.
- !** The On-body Injector is for adult patients only.
- !** Store Neulasta Onpro kit in the refrigerator at 36°F to 46°F (2°C to 8°C) until ready for use. If Neulasta Onpro kit is stored at room temperature for more than 12 hours, do not use. Start again with a new Neulasta Onpro kit.
- !** Keep the prefilled syringe in the Neulasta Onpro kit carton until use to protect from light.
- !** For patients who have had severe skin reactions to acrylic adhesives, consider the benefit:risk profile before administering pegfilgrastim via the On-body Injector for Neulasta.
- !** The On-body Injector should be applied to intact, non-irritated skin on the abdomen or back of the arm. The back of the arm may only be used if there is a caregiver available to monitor the status of the On-body Injector.
- ⊘** DO NOT:
  - x** freeze Neulasta Onpro kit.
  - x** shake the prefilled syringe.
  - x** separate the components of Neulasta Onpro kit until ready for use.
  - x** modify the On-body Injector.
  - x** warm Neulasta Onpro kit components using a heat source.
  - x** use Neulasta Onpro kit if expiry date on the carton or any of the Neulasta Onpro kit components has passed.
  - x** use if the name Neulasta does not appear on the Neulasta Onpro kit carton.
  - x** attempt to reapply On-body Injector.
  - x** use if either the On-body Injector or prefilled syringe is dropped. Start again with a new Neulasta Onpro kit.

For all questions, call Amgen at 1-800-772-6436. If a patient calls you regarding any On-body Injector problems, call Amgen at 1-800-772-6436.

## Step 1: Prepare

### **A Remove Neulasta Onpro kit from refrigerator. Check to make sure it contains:**

- One Neulasta prefilled syringe
- One On-body Injector for Neulasta
- Neulasta package insert
- Instructions for use:
  - for healthcare provider
  - for patient
- Reference guide

- ⊘ DO NOT use On-body Injector if its packaging has been previously opened.

**B Wash hands thoroughly. Prepare and clean On-body Injector application site.**

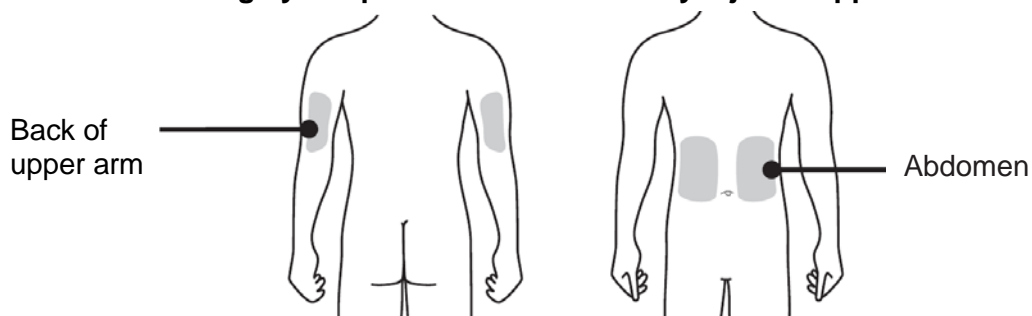

**Choose the flattest site for On-body Injector application. Consult with your patient regarding their ability to remove and monitor the entire On-body Injector.**

You can use:

- Left or right side of abdomen, except for a 2-inch area right around navel.
- Back of upper arm, only if there is a caregiver available to monitor the status of the On-body Injector.

Choose an area larger than the adhesive pad, and clean it with an alcohol swab. Allow skin to completely dry.

- ⊘ DO NOT touch this area again before attaching On-body Injector.

You should avoid:

- ✗ Areas with scar tissues, moles, or excessive hair. In case of excessive hair, carefully trim hair to get On-body Injector close to skin.
- ✗ Areas where belts, waistbands, or tight clothing may rub against, disturb, or dislodge On-body Injector.
- ✗ Surgical sites.
- ✗ Areas where On-body Injector will be affected by folds in skin.



**The following is an overview of On-body Injector preparation steps. Read this section first.**

**When ready, proceed to Step 2: Get Ready Section.**

Before you apply On-body Injector to your patient, locate medicine port on blue needle cover to fill the On-body Injector with Neulasta.

**Please note:** During filling, beeping will sound and the On-body Injector will be activated.

**After activation, you will have 3 minutes to:**

1. Completely empty syringe contents into medicine port.
2. Remove syringe from port and pull down needle safety guard over the exposed needle.
3. Remove blue needle cover from back of On-body Injector.
4. Peel away the two pieces of white adhesive backing from the back of the On-body Injector.
5. Attach On-body Injector to back of patient's upper arm or abdomen.

On-body Injector will deploy cannula in 3 minutes, even if not applied to patient. If not on patient's body in 3 minutes, do not use the On-body Injector. Start again with a new Neulasta Onpro kit.

**When you feel you are ready, please continue...**

## Step 2: Get Ready

**A Remove Neulasta prefilled syringe from tray.**

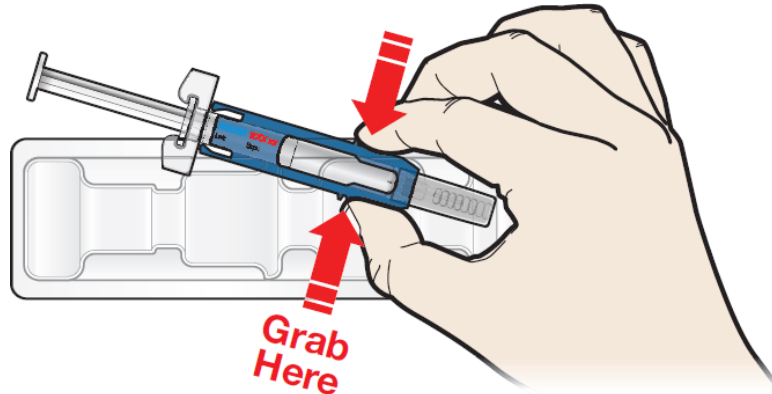

For safety reasons:

- ⊘ DO NOT grasp gray needle cap.
- ⊘ DO NOT put the gray needle cap back onto syringe.
- ⊘ DO NOT grasp clear plunger.

**B Inspect medicine and Neulasta prefilled syringe. The Neulasta liquid should always be clear and colorless.**

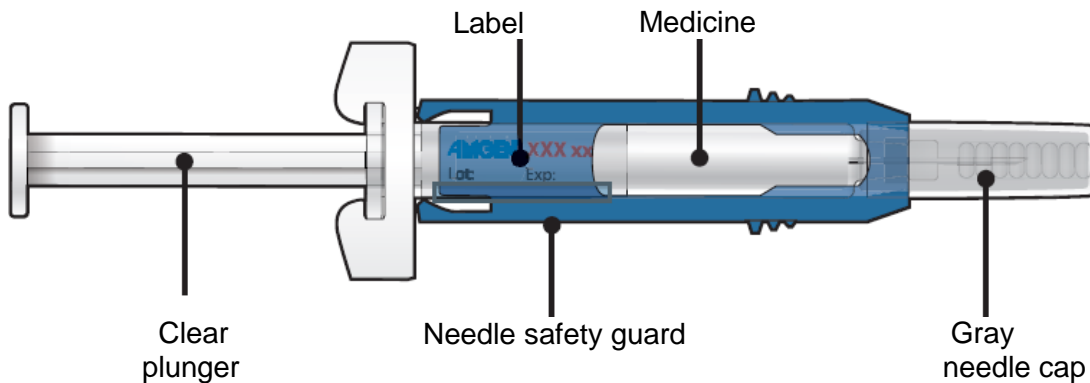

- ⊘ DO NOT use Neulasta prefilled syringe if:
  - ✗ Liquid contains particulate matter or discoloration is observed prior to administration.
  - ✗ Any part appears cracked or broken.
  - ✗ The gray needle cap is missing or not securely attached.
  - ✗ The expiration date printed on the label has passed.
- ⊘ DO NOT remove gray needle cap until ready to fill On-body Injector.
- ⊘ DO NOT pull needle safety guard down over the needle until filling is complete.
- ❗ In all the above cases, start again with a new Neulasta Onpro kit. Call Amgen at 1-800-772-

6436.

- !** The prefilled syringe gray needle cap contains dry natural rubber, which is derived from latex.
- C** **Carefully remove gray needle cap straight out from the syringe and away from your body. Check syringe, and remove air bubbles.**

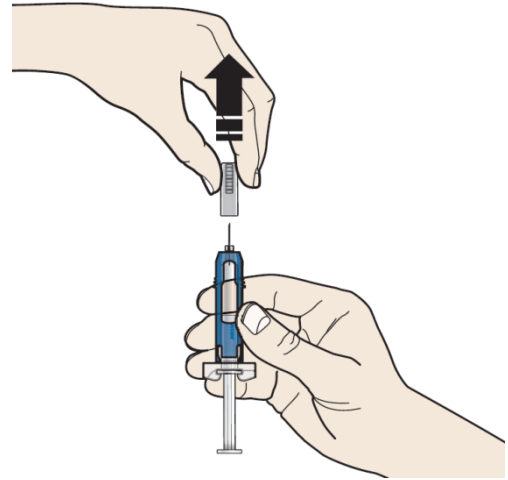

- !** Take care to expel air only and not medicine. A small droplet at the tip of the needle during air purging is normal.
- ⊘ DO NOT recap syringe.

- D** Using blue needle cover, to avoid bending the needle and spilling medicine, insert syringe needle at 90 degrees all the way into medicine port. Slowly empty the entire syringe contents. Remove empty syringe from the medicine port. When beeping sounds and the status light flashes amber, the 3-minute countdown begins.

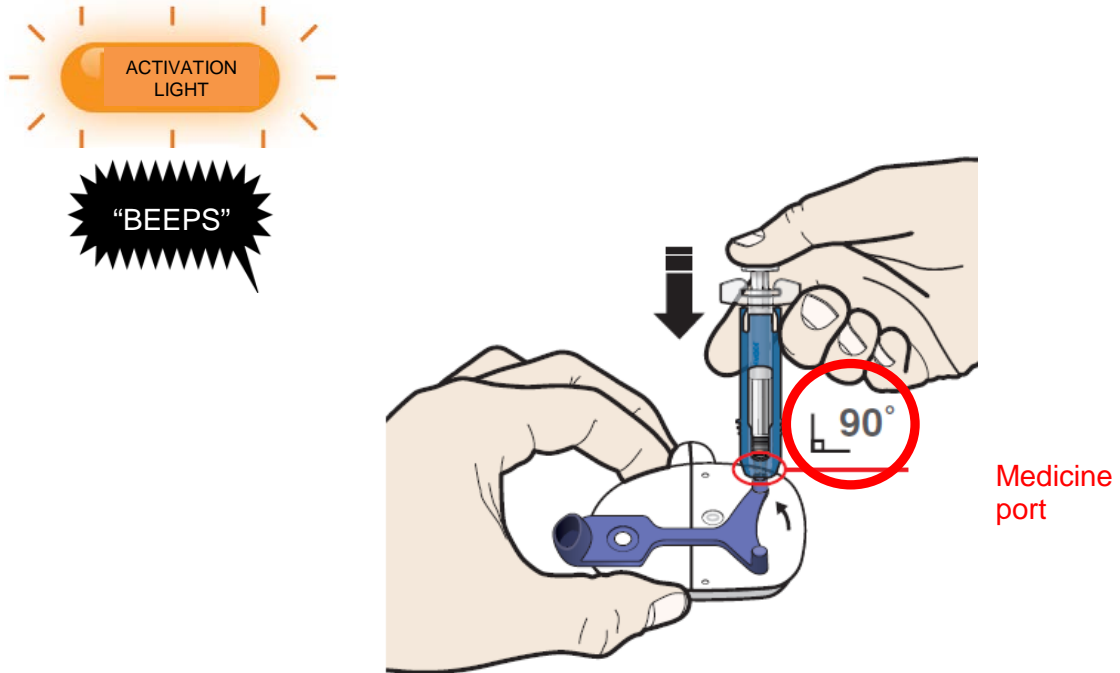

- ⊘ DO NOT insert needle into medicine port at other than a 90 degree angle
- ⊘ DO NOT insert needle more than once.
- ⊘ DO NOT remove blue needle cover before filling the On-body Injector.

- E** Pull needle safety guard down until it clicks and covers needle. Dispose of empty syringe in a sharps container.

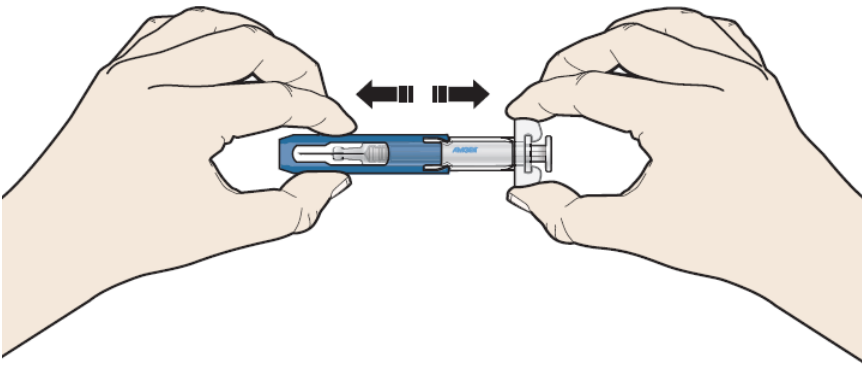

**F Check to see if the On-body Injector is full.**

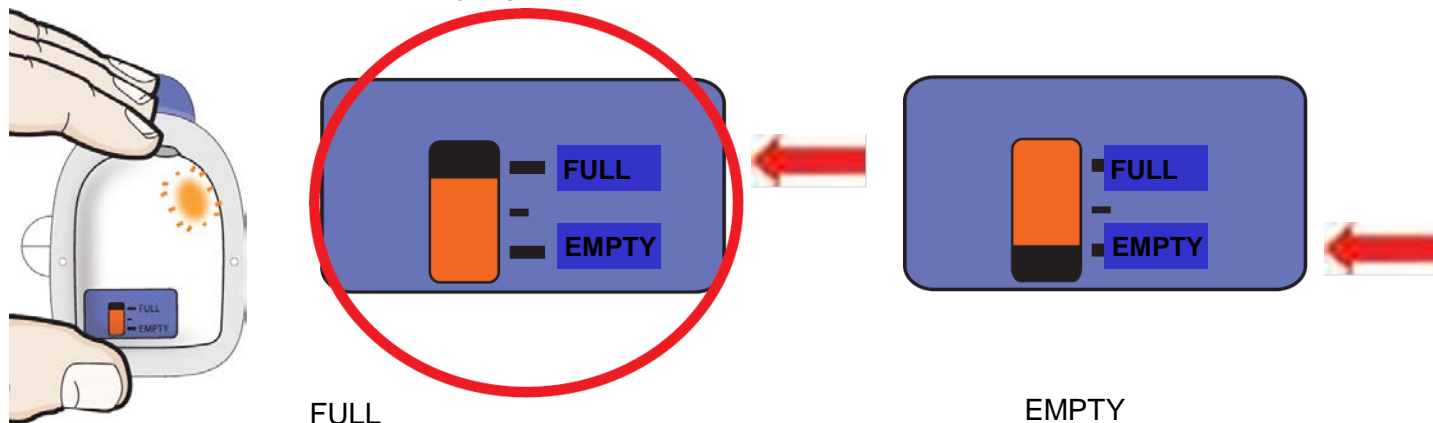

You should see:

- amber status light flashing.
- black line next to FULL on the fill indicator

If this is not the case, do not use. Start again with a new Neulasta Onpro kit, and call Amgen at 1-800-772-6436.

**Step 3: Apply**

**A Firmly lift and remove blue needle cover away from On-body Injector.**

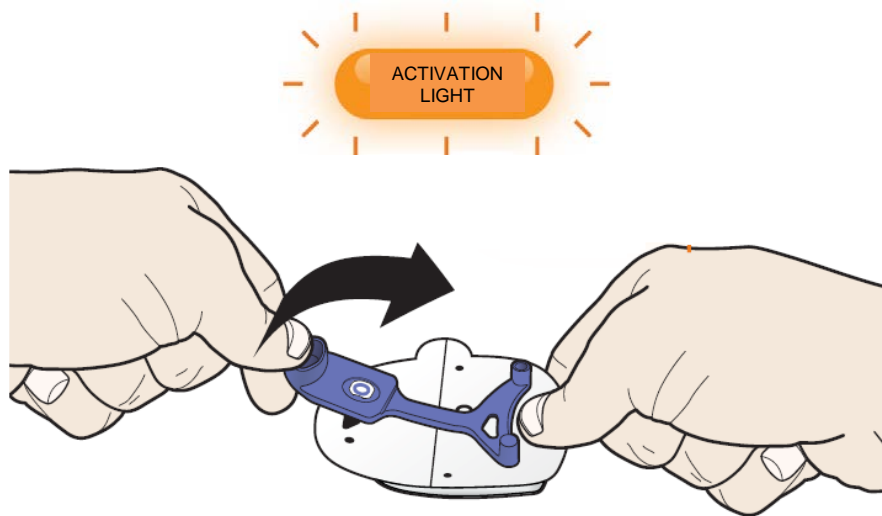

A drop of medicine may be visible on needle tip when blue needle cover is removed.

- B To expose the adhesive pad, use both pull tabs, one at a time, to peel the two pieces of white adhesive backing away from On-body Injector.**

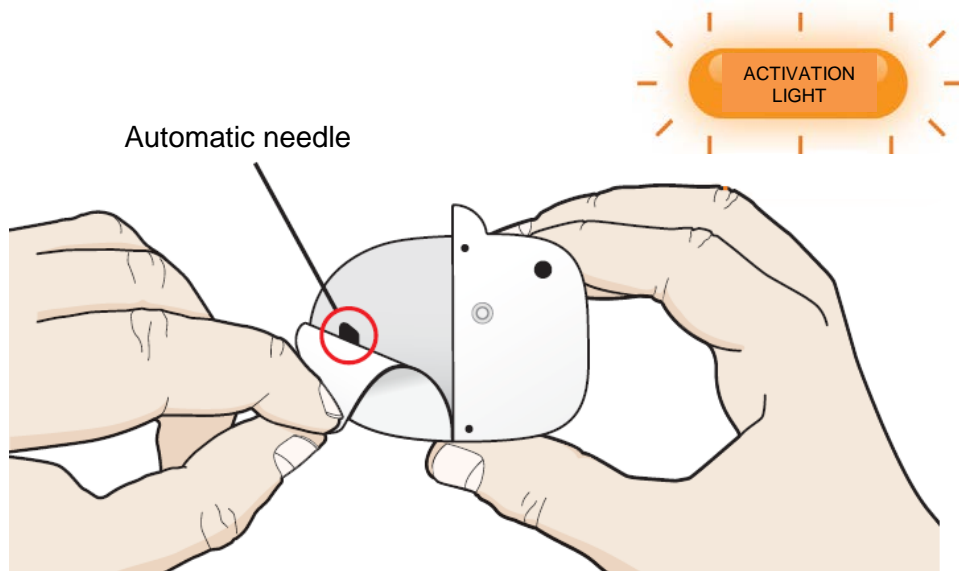

- ⊘ DO NOT touch or contaminate automatic needle area.
- ⊘ DO NOT pull off adhesive pad or fold it.
- ⊘ DO NOT use if the needle or cannula is extended past the adhesive or is extended before the On-body Injector is placed on patient.

**!** In all cases, start again with a new Neulasta Onpro kit. Call Amgen at 1-800-772-6436.

- C Apply On-body Injector securely to patient with entire On-body Injector visible so it can be monitored by patient or caregiver. Before cannula deploys, place On-body Injector on your selected site, and run your finger around entire adhesive pad to make sure it is securely attached.**

**Back of Upper Arm**



Vertical with light facing down toward elbow

Horizontal  
with light  
facing  
navel

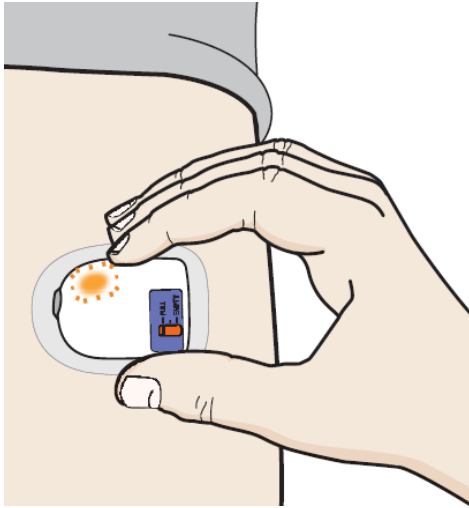

### Abdomen



**STOP! Do not worry if On-body Injector is quiet. When 3 minutes are up, On-body Injector will beep.**

- D Beeping will tell you the cannula is about to insert. You may hear a series of clicks. This is okay.  
A long beep will sound, and the status light will turn to green. This means the cannula insertion is complete.**

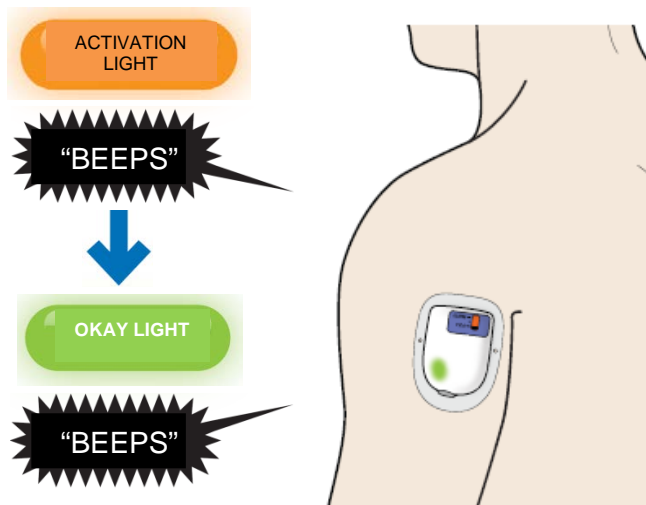

If the adhesive folds over near the cannula window or there are folds anywhere that prevent the On-body Injector from securely adhering, remove the On-body Injector. Start again with a new Neulasta Onpro kit and call Amgen at 1-800-772-6436.



## Step 4: Finish

- A Fill in the Dose Delivery Information section in the patient instructions. Be sure to include when the On-body Injector was applied, when the dose will begin, and your contact information. Review this information with the patient.**

Review each step in the patient instructions with your patient. Give your patient the instructions, and reference guide to take home.

Before your patient goes home, make sure your patient understands:

- The On-body Injector will always flash a slow green light to let them know it is working properly.
- **After approximately 27 hours, beeps will signal that the dose delivery will begin in 2 minutes.**
- **When the dose delivery starts it will take about 45 minutes to complete. During this time, the On-body Injector will flash a fast green light.**
- The patient should remain in a place where they can monitor the On-body Injector for the entire dose delivery. The patient should avoid activities and settings that may interfere with monitoring during the dosing of Neulasta administered by the On-body Injector. For example, avoid traveling, driving, or operating heavy machinery during hours 26-29 following application of the On-body Injector (this includes the approximately 45-minute delivery period plus an hour post-delivery).
- If the patient has an allergic reaction during the delivery of Neulasta, the patient should remove the On-body Injector and call his or her healthcare provider or seek emergency care right away.
- If placed on the back of the arm, remind the patient that a caregiver must be available to monitor the On-body Injector.
- When the dose delivery is complete, the patient or caregiver will hear a beep and see a solid green light.
- Always dispose of the empty On-body Injector in a sharps disposal container as instructed by your healthcare provider or by state or local laws.
- Keep the On-body Injector at least 4 inches away from electrical equipment such as cell phones, cordless telephones, microwaves and other common appliances. Failure to keep the On-body Injector at least this recommended distance may interfere with operation and can lead to a missed or incomplete dose of Neulasta.

## Attention!

What to do if you hear beeping or when you look at status light and it is flashing red.

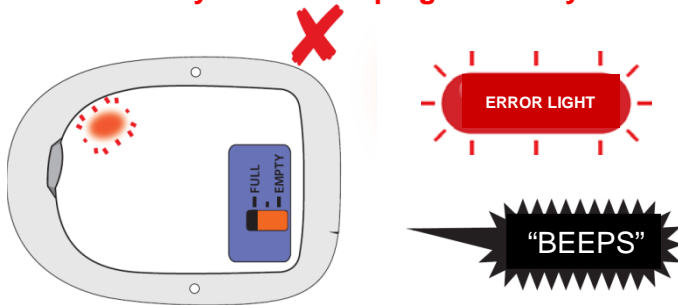

If at any time the On-body Injector beeps continuously for 5 minutes, and the status light is flashing red, take the On-body Injector off of the patient.

- ⊘ DO NOT apply On-body Injector to patient if red error light is on.
  - ⊘ DO NOT leave On-body Injector on patient if red error light is on.
- In all cases, do not use. Start over with a new Neulasta Onpro kit, and call Amgen at 1-800-772-6436.

What to do if the adhesive becomes saturated with fluid or the On-body Injector is dripping.

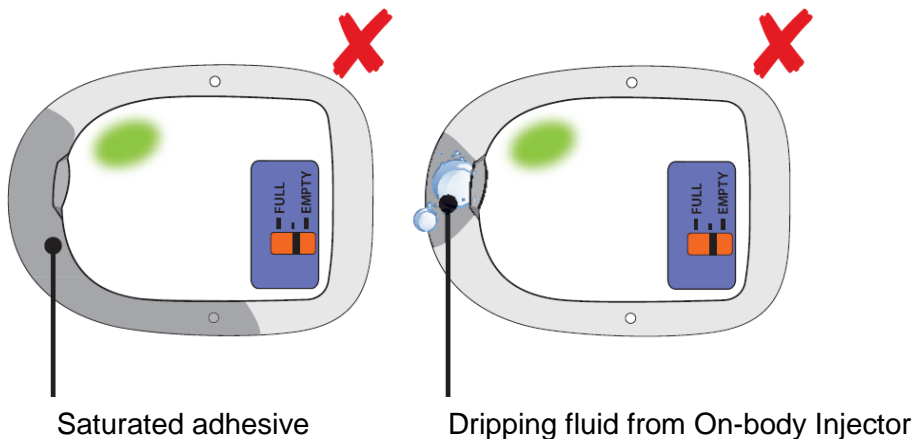

If patient reports an On-body Injector leak, they might not have received full dose. Schedule a follow-up appointment, and report the incident to Amgen at 1-800-772-6436.

Neulasta® (pegfilgrastim)

**Manufactured by:**

Amgen Inc.

One Amgen Center Drive

Thousand Oaks, California 91320-1799

© 2002 to 2015 Amgen Inc. All rights reserved.















www.neulasta.com 1-800-772-6436 (1-800-77-AMGEN)

Issued: 09/2015

v3

Do not expose the On-body Injector for Neulasta to the following environments as the On-body Injector may be damaged and the patient could be injured:

- MRI
- X-ray
- CT-Scan
- Ultrasound
- Oxygen rich environments such as hyperbaric chambers

Symbol	Meaning
	Do not reuse this On-body Injector. Single-use only
	Refer to Instructions for Use
	Do not use if packaging is damaged.
	Temperature Limitation
	Humidity Limitation
	Expiration Date (use by date)
	Reference/model number
	Lot Number
	Type BF medical device (protection from electrical shock)
	Sterilized by ethylene oxide
	Waterproof up to 8 feet for 1 hour
	Prescription use only
	Not MRI-safe
	On-body Injector for Neulasta® (pegfilgrastim)
	Neulasta® (pegfilgrastim) Prefilled Syringe

## Electromagnetic Compatibility

The information contained in this section (such as separation distances) is, in general, specifically written in regard to the On-body Injector for Neulasta. The numbers provided will not guarantee faultless operation but should provide reasonable assurance of such. This information may not be applicable to other medical electrical equipment; older equipment may be particularly susceptible to interference.

### General Notes:

Medical electrical equipment requires special precautions regarding electromagnetic compatibility (EMC), and needs to be installed and put into service according to the EMC information provided in this document.

Portable and mobile RF communications equipment can affect medical electrical equipment.

Cables and accessories not specified within the instructions for use are not authorized. Using cables and/or accessories may adversely impact safety, performance, and electromagnetic compatibility (increased emission and decreased immunity).

Care should be taken if the On-body Injector for Neulasta is used adjacent to other electrical equipment; if adjacent use is inevitable, the On-body Injector for Neulasta should be observed to verify normal operation in this setting.

Electromagnetic Emissions		
The On-body Injector for Neulasta is intended for use in the electromagnetic environment specified below. The user of the On-body Injector for Neulasta should ensure that it is used in such an environment.		
Emissions	Compliance according to	Electromagnetic environment
RF Emissions (CISPR 11)	Group 1	The On-body Injector for Neulasta uses RF energy only for its internal function. Therefore, its RF emissions are very low and are not likely to cause any interference in nearby equipment.
CISPR B Emissions Classification	Class B	

## Electromagnetic Immunity

The On-body Injector for Neulasta is intended for use in the electromagnetic environment specified below. The user of this equipment should ensure that it is used in such an environment.

Immunity Test	IEC 60601 Test Level	Compliance Level	Electromagnetic Environment – Guidance
ESD IEC 61000-4-2	±6kV Contact ±8kV Air	6kV Contact ±8kV Air	Floors should be wood, concrete or ceramic tile. If floors are synthetic, the r/h should be at least 30%.
Power Frequency 50/60 Hz Magnetic Field IEC 61000-4-8	3A/m	3A/m	Power frequency magnetic fields should be that of typical commercial or hospital environment.
Radiated RF Fields 61000-4-3	3 V/m 80 MHz to 2.5 GHz	(E1)=3V/m	<p>Portable and mobile communications equipment should be separated from the On-body Injector for Neulasta by no less than the distances calculated/listed below:</p> <p><math>D=(3.5/V1)(\sqrt{P})</math> 150 kHz to 80 MHz</p> <p><math>D=(3.5/E1)(\sqrt{P})</math> 80 to 800 MHz</p> <p><math>D=(7/E1)(\sqrt{P})</math> 800 MHz to 2.5 GHz</p> <p>Where P is the max power in watts and D is the recommended separation distance in meters. Field strengths from fixed transmitters, as determined by an electromagnetic site survey, should be less than the compliance levels (V1 and E1). Interference may occur in the vicinity of equipment containing a transmitter.</p>

## Recommended separation distances between portable and mobile RF communications equipment and the On-body Injector for Neulasta

You can help prevent electromagnetic interference by maintaining a minimum distance between portable and mobile RF communications equipment (transmitters) and the On-body Injector for Neulasta, as recommended below, according to the maximum power of the communication equipment.

Rated maximum output power of transmitter, in watts	Separation distance according to frequency of transmitter, in meters		
	150 kHz to 80 MHz $D=(3.5/V1)(\sqrt{P})$	80 to 800 MHz $D=(3.5/E1)(\sqrt{P})$	800 MHz to 2.5 GHz $D=(7/E1)(\sqrt{P})$
0.01	0.11667	0.11667	0.23333
0.1	0.36894	0.36894	0.73785
1	1.1667	1.1667	2.3333
10	3.6894	3.6894	7.3785
100	11.667	11.667	23.333

## {SIDE 1 Information}

### Patient Instructions for Use

#### On-body Injector for Neulasta Description

The On-body Injector for Neulasta is intended for delivery of Neulasta. The On-body Injector is small, for one-time use, lightweight, battery-powered, and waterproof up to 8 feet for 1 hour. Your healthcare provider will use a prefilled syringe with Neulasta to fill the On-body Injector prior to applying it. The prefilled syringe with Neulasta and the On-body Injector are provided to your healthcare provider as part of Neulasta Onpro™ kit. The On-body Injector is applied directly to your skin using a self-adhesive backing. The On-body Injector informs you of its status with sounds and lights.

The On-body Injector contains electronic components as well as: a plastic housing, acrylic adhesive, batteries, a cannula introducer (needle) and a cannula. The On-body Injector is approximately: 2.4 in long, 1.6 in wide, 0.7 in height (62 mm long, 41 mm wide, 17 mm height).

#### Warnings

- **Before** you receive Neulasta, tell your healthcare provider if you:
  - Have sickle cell trait or sickle cell disease
  - Have problems with your kidneys
  - Have any other medical problems
  - Are pregnant or plan to become pregnant. It is not known if Neulasta may harm your unborn baby.
  - Are breastfeeding or plan to breastfeed. It is not known if Neulasta passes into your breastmilk.
- **DO NOT** take Neulasta if you have had a serious allergic reaction to pegfilgrastim (Neulasta®) or to filgrastim (Neupogen®).
- Tell your healthcare provider if you are allergic to latex. A prefilled syringe is used to fill the On-body Injector by your healthcare provider prior to applying the On-body Injector. The prefilled syringe gray needle cap contains dry natural rubber, which is derived from latex. Latex may be transferred to your skin.
- Tell your healthcare provider if you have had severe skin reactions to acrylic adhesives.
- The On-body Injector is for adult patients only.
- Avoid activities and places that may interfere with monitoring during the dosing of Neulasta administered by the On-body Injector. For example, **AVOID** traveling, driving, or operating heavy machinery during hours 26-29 following application of the On-body Injector for Neulasta (this includes the 45-minute dose delivery period plus an hour post-delivery). If you must travel by airplane **before** the approximately 45-minute dose delivery period with the On-body Injector, avoid airport X-ray scans. Request a manual pat down instead. Use care during a manual pat down to help prevent the On-body Injector from being accidentally removed. For more information go to <http://www.tsa.gov/traveler-information/travelers-disabilities-and-medical-conditions>
- If you have an allergic reaction during the delivery of Neulasta, remove the On-body Injector by grabbing the edge of the adhesive pad and peeling off the On-body Injector. Get emergency medical help right away.
- Call your healthcare provider immediately if you have severe pain or skin discomfort around your On-body Injector.



- Call your healthcare provider right away if you have pain in your left upper stomach area or left shoulder area. This pain could mean your spleen is enlarged or ruptured.
- Call your healthcare provider or get emergency medical help right away if you get any of these symptoms of acute respiratory distress syndrome (ARDS): fever, shortness of breath, trouble breathing, or a fast rate of breathing.
- Call your healthcare provider right away if you experience any of these symptoms of kidney injury (glomerulonephritis): puffiness in your face or ankles, blood in your urine or brown colored urine or you notice you urinate less than usual.
- Keep children away from the used On-body Injector.
- You should only receive a dose of Neulasta on the day your healthcare provider tells you.
- You should not receive your dose of Neulasta any sooner than 24 hours after you finish receiving your chemotherapy. The On-body Injector for Neulasta is programmed to deliver your dose about 27 hours after your healthcare provider places the On-body Injector on your skin.
- **DO NOT** expose the On-body Injector to the following because the On-body Injector may be damaged and you could be injured:
  - MRI
  - X-ray
  - CT-Scan
  - Ultrasound
  - Oxygen rich environments, such as hyperbaric chambers
- **DO NOT** use hot tubs, whirlpools, or saunas while wearing the On-body Injector. This may affect your medicine.
- **DO NOT** expose the On-body Injector to direct sunlight. If the On-body Injector is exposed to direct sunlight for more than 1 hour, it may affect your medicine. Wear the On-body Injector under clothing.
- **DO NOT** sleep on the On-body Injector or apply pressure during wear, especially during dose delivery. This may affect the On-body Injector performance.
- **DO NOT** peel off or disturb the On-body Injector's adhesive before your full dose is complete. This may result in a missed or incomplete dose of Neulasta.

## Precautions

### Environmental:

- Keep the On-body Injector dry for the last 3 hours prior to the dose delivery start.
- Only expose the On-body Injector to temperatures between 41°F and 104°F (5°C-40°C).
- Keep the On-body Injector at least 4 inches away from electrical equipment such as cell phones, cordless telephones, microwaves and other common appliances. Failure to keep the On-body Injector at least this recommended distance may interfere with operation and can lead to a missed or incomplete dose of Neulasta.

### Activity Related:

- Avoid getting body lotions, creams, oils or cleaning agents near the On-body Injector as these products may loosen the adhesive.
- Be careful not to bump the On-body Injector or knock the On-body Injector off your body.

### Biohazard:

Properly dispose of the On-body Injector:

- The On-body Injector contains batteries, electronics, and a needle. The On-body Injector should be placed in a sharps disposal container, with an appropriate sized opening, regardless of whether or not the needle is exposed. Follow instructions provided by your healthcare provider or by state or local laws.
- To participate in Amgen's voluntary disposal program, please call 1-844-MYNEULASTA (1-844-696-3852) or visit [www.neulasta.com](http://www.neulasta.com) to enroll.
- For more information about safe sharps disposal, and for specific information about sharps disposal in the state that you live in, go to FDA's website at: <http://www.fda.gov/safesharpsdisposal>.

## Risks

You can avoid most risks related to using the On-body Injector for Neulasta by following the Patient Instructions for Use. Immediately call your healthcare provider if any of the following occur:

- The adhesive becomes noticeably wet (saturated) with fluid, or you see dripping
- If the On-body Injector fill indicator is not at the empty position after On-body Injector removal (You should see a black line next to the EMPTY indicator.)
- The On-body Injector comes off from the skin before or during a dose delivery (**DO NOT re-apply it.**)
- Status light is flashing red
- Allergic reaction
- Persistent or worsening redness or tenderness at the application site (may be a sign of infection)
- Severe pain or skin discomfort around your On-body Injector
- Any concern about your medication
- If the needle is exposed after On-body Injector removal

{SIDE 2 Information}

## On-body Injector for Neulasta® (nu-las-tah) (pegfilgrastim) Injection Patient Instructions for Use

### Dose Delivery Information

Your On-body Injector was applied:

---

Day	Time	AM / PM
-----	------	---------

Your dose delivery will start around:

---

Day	Time	AM / PM
-----	------	---------

Name of Healthcare Provider:

---

Last, First

Healthcare Provider contact number:

---

On-body Injector lot number:

### Important Information

- !** This On-body Injector delivers Neulasta with an under-the-skin (subcutaneous) injection. See Patient Information for medicine information.
- !** If you have concerns about your medication, call your healthcare provider immediately. Serious allergic reactions can happen with Neulasta. Ask your caregiver to be nearby for the first use.
- !** Plan to be in a place where you or your caregiver can appropriately monitor the On-body Injector for Neulasta during the approximately 45 minute Neulasta delivery and for an hour after the delivery.
- !** Avoid activities and places that may interfere with monitoring during the dosing of Neulasta administered by the On-body Injector (hours 26-29).

- ❗ If you have an allergic reaction during the delivery of Neulasta, remove the On-body Injector by grabbing the edge of the adhesive pad and peeling off the On-body Injector. Get emergency medical help right away.
  - ❗ The On-body Injector should be applied to intact, non-irritated skin on the stomach area (abdomen) or back of the arm. The back of the arm may only be used if there is a caregiver available to monitor the status of the On-body Injector.
  - ❗ Call your healthcare provider immediately if you have severe pain or skin discomfort around your On-body Injector.
  - ❗ Be careful not to bump the On-body Injector or knock the On-body Injector off your body.
  - ❗ Avoid getting body lotions, creams, oils or cleaning agents near the On-body Injector as these products may loosen the adhesive.
  - ❗ Keep the On-body Injector dry for the last 3 hours prior to the dose delivery start.
  - ❗ Only expose the On-body Injector to temperatures between 41°F and 104°F (5°C and 40°C).
  - ❗ After On-body Injector removal, properly dispose of it in a sharps disposal container as instructed by your healthcare provider or by state or local laws.
  - ❗ Keep the On-body Injector at least 4 inches away from electrical equipment such as cell phones, cordless telephones, microwaves and other common appliances. Failure to keep the On-body Injector at least this recommended distance may interfere with operation and can lead to a missed or incomplete dose of Neulasta.
- ⊘ **DO NOT:**
- ✗ use hot tubs, whirlpools, or saunas while wearing the On-body Injector. This may affect your medicine.
  - ✗ expose the On-body Injector to direct sunlight. If the On-body Injector is exposed to direct sunlight for more than 1 hour, it may affect your medicine. Wear the On-body Injector under clothing.
  - ✗ sleep on the On-body Injector or apply pressure during wear, especially during dose delivery. This may affect On-body Injector performance.
  - ✗ peel off or disturb the On-body Injector adhesive before your full dose is complete. This may result in a missed or incomplete dose of Neulasta.

A healthcare provider who is familiar with Neulasta should answer your questions. For general questions or support call 1-844-MYNEULASTA (1-844-696-3852) or visit [www.neulasta.com](http://www.neulasta.com).

## Guide to Parts for On-body Injector for Neulasta

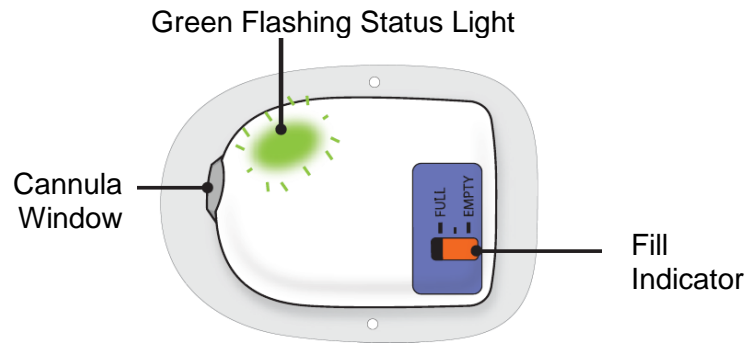

The On-body Injector is working properly.

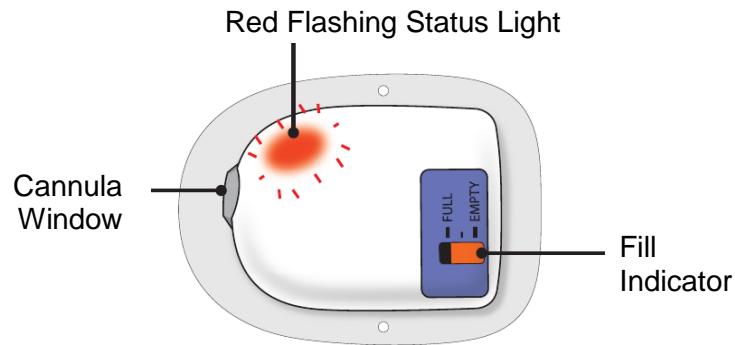

If at any time you hear beeping, check the status light. If it is flashing red, call your healthcare provider immediately.

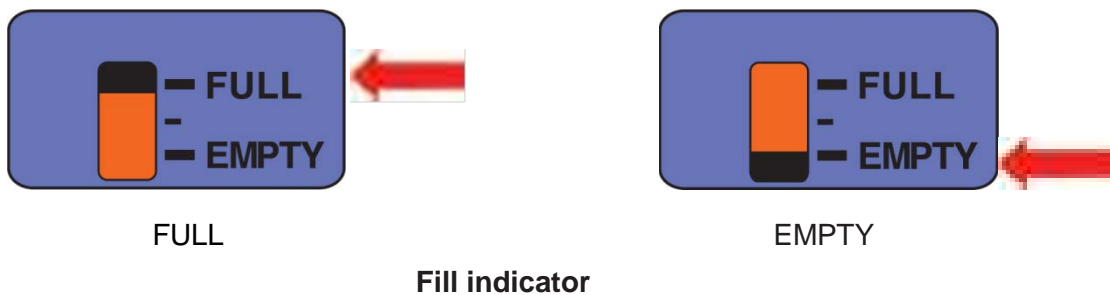

After your dose delivery is complete, check to see if the black line on your On-body Injector fill indicator is at empty.

## On-body Injector Placement

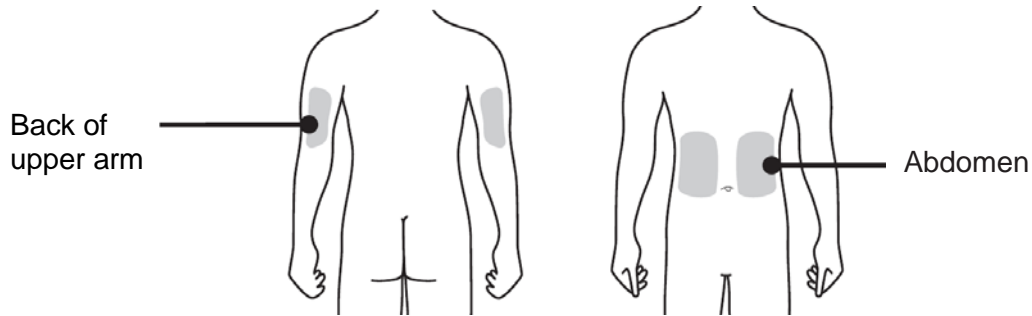

### Step 1: Monitor On-body Injector

- A Check your status light occasionally for approximately 27 hours. Since it flashes slowly, watch for at least 10 seconds. If the status light is flashing green, it is okay.**
- !** If at any time you hear beeping, check the status light. If it is flashing red, call your healthcare provider immediately.



If the On-body Injector for Neulasta was placed on the back of your arm, a caregiver must be available to monitor the status of the On-body Injector.

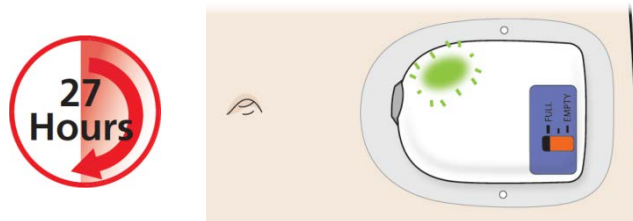

**B** After approximately 27 hours, your On-body Injector will beep to let you know your dose delivery will begin in 2 minutes. When the dose delivery starts, it will take about 45 minutes to complete. During this time, the On-body Injector will flash a fast green light.

**!** If at any time you hear beeping, check the status light. If it is flashing red, call your healthcare provider immediately.

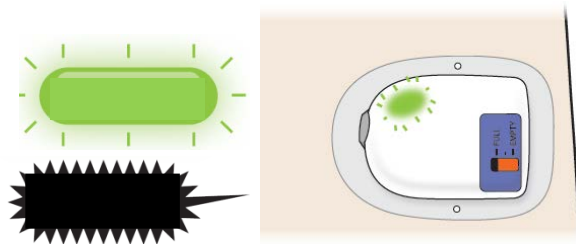

⊘ DO NOT remove the On-body Injector before the dose delivery is complete.

## Step 2: Monitor Dose Delivery



For the next 45 minutes, monitor your On-body Injector frequently for leaks during dose delivery. If the On-body Injector was placed on the back of your arm, a caregiver must be available to monitor your On-body Injector.

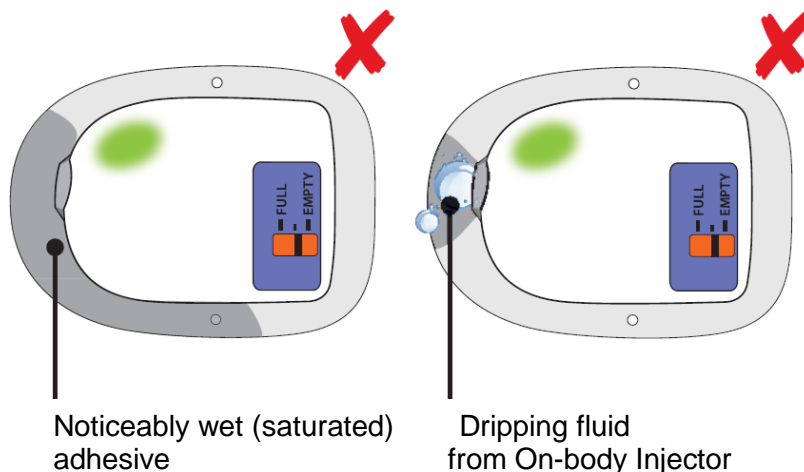

Noticeably wet (saturated) adhesive

Dripping fluid from On-body Injector

If the adhesive becomes noticeably wet (saturated) with fluid, or you see dripping, call your healthcare provider immediately.

**A Your dose delivery will take around 45 minutes to complete.**

- You may hear a series of clicks. This is okay.
- A beep will sound when the dose delivery is complete.

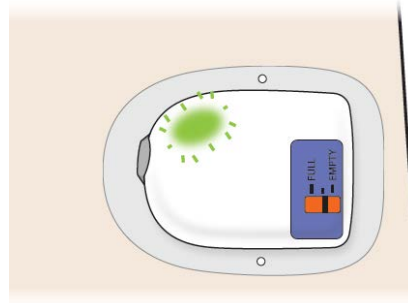

**Step 3: Remove On-body Injector When Dose Delivery Is Complete**

**A When beeping starts, check to see the color of the status light.**

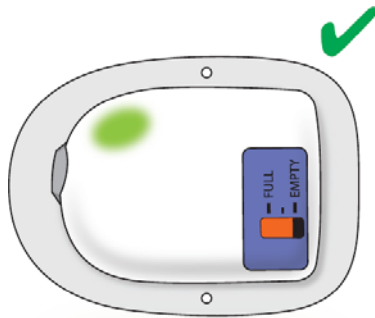

Check to see if the status light is SOLID GREEN or has switched off. This means the dose is complete. Remember, **any time you see a leak, call your healthcare provider immediately.** If the dose is complete, go to the next step.

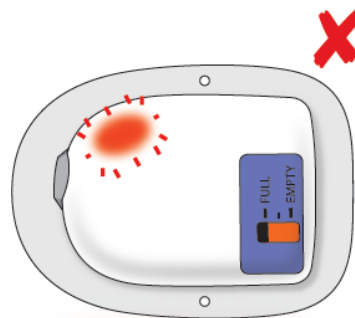

If you see the status light is flashing red, your On-body Injector is not functioning properly. Call your healthcare provider immediately, as you may not have received a full dose.



**B Grab the edge of the adhesive pad. Slowly peel off the On-body Injector.**

- If medicine has leaked or the adhesive is noticeably wet (saturated), call your healthcare provider immediately as you may not have received your full dose.
- Remove any extra adhesive using soap and water.

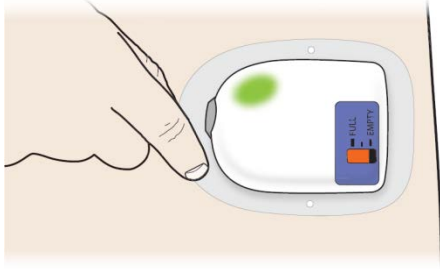

⊘ **DO NOT** grasp the On-body Injector itself to try to pull it off of your body.

**Step 4: Finish**



**Check to see if your On-body Injector is empty.**

- You should see a black line next to the EMPTY indicator. If the On-body Injector is not empty, call your healthcare provider immediately.

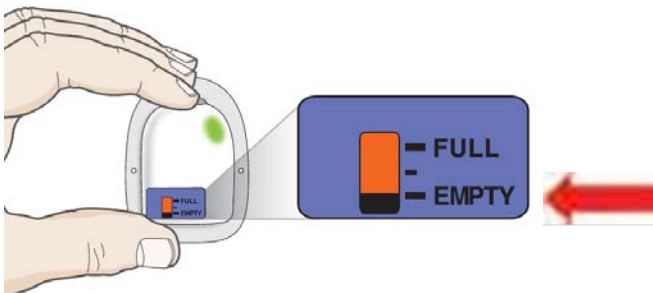

- Check your status light again. Watch for at least 10 seconds. If the status light is solid green or it has switched off, it is okay.
  - If you hear beeping, or when you check the status light and it is flashing red, call your healthcare provider immediately.
- !** After On-body Injector removal, place the On-body Injector in a sharps disposal container whether the needle is exposed or not. If the needle is exposed, call your healthcare provider immediately.

**A Record the end state of your On-body Injector.**

- Mark the box of the description that represents your On-body Injector after it has been used.

**Status light is solid green or the status light has switched off. This means that the delivery is complete.**

**On-body Injector leaked, call your healthcare provider immediately.**

**Status light is red, call your healthcare provider immediately.**

**B Properly dispose of the On-body Injector.**

- The On-body Injector contains batteries, electronics, and a needle. Dispose of it in a sharps disposal container as instructed by your healthcare provider or by state or local laws.
- To participate in Amgen's voluntary disposal program, please call 1-844-MYNEULASTA (1-844-696-3852) or visit [www.neulasta.com](http://www.neulasta.com) to enroll. For more information about safe sharps disposal, and for specific information about sharps disposal in the state that you live in, go to FDA's website at: <http://www.fda.gov/safesharpsdisposal>.

**!** Keep children away from the used On-body Injector.

**Attention!**

**What to do if you hear beeping or when you look at the status light and it is flashing red.**

**!** If the status light is flashing red, you may not have received your full dose. Call your healthcare provider immediately.

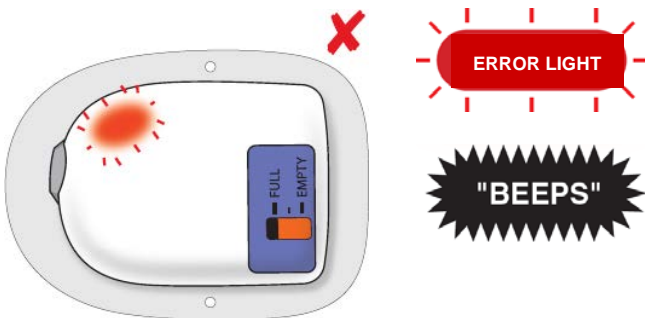

**What to do if the On-body Injector adhesive becomes noticeably wet (saturated) with fluid, or you see dripping.**

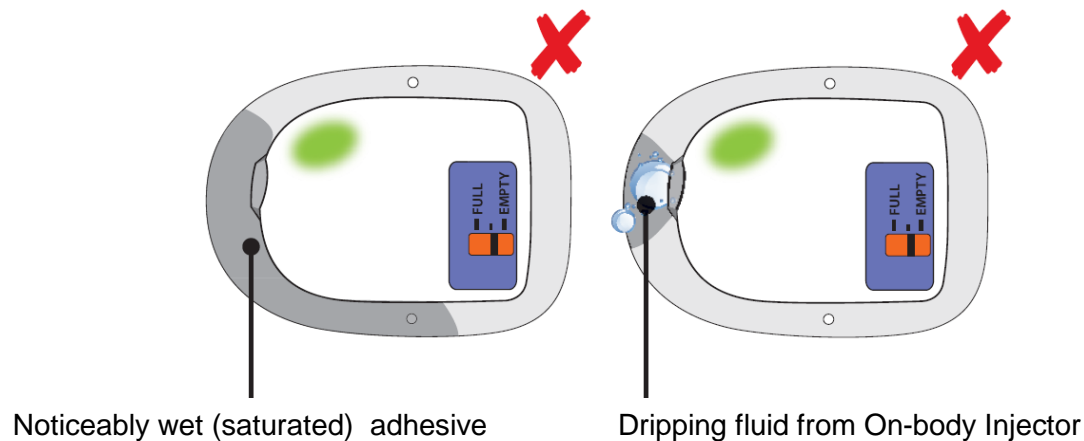

- ! If the adhesive becomes saturated with fluid, or you see dripping, your medicine may have leaked out.
- ! Even with a leak, the status light may remain green and the fill indicator may be at EMPTY.
- ! Call your healthcare provider immediately as you may not have received your full dose.

**Note:** It is normal to see a few drops of fluid at the application site, but not normal to see a noticeably wet (saturated) adhesive.

**What do I do if the On-body Injector comes off before the full dose is delivered?**

Call your healthcare provider immediately if the On-body Injector at any time comes away from your skin before your full dose delivery, **DO NOT** reapply it.

**What if there is blood at my application site after the On-body Injector has been removed?**

If there is blood, press a clean cotton ball or gauze pad on the application site. Apply an adhesive bandage if needed.

**What if my application site is red or tender after On-body Injector removal?**

Call your healthcare provider immediately if you experience persistent or worsening redness or tenderness at the application site, as this can be a sign of infection.



Neulasta® (pegfilgrastim)

**Manufactured by:**

Amgen Inc.  
One Amgen Center Drive  
Thousand Oaks, California 91320-1799  
US License No. 1080

Patent: <http://pat.amgen.com/neulasta/>

© 2002 to 2015 Amgen Inc. All rights reserved.

[www.neulasta.com](http://www.neulasta.com)

1-844-MYNEULASTA (1-844-696-3852) Issued: 11/2015 vX

**Patient Information**  
**Neulasta® (nu-las-tah)**  
**(pegfilgrastim)**  
**injection**  
**On-body Injector for Neulasta**

Read this Patient Information before you receive Neulasta and each time you receive Neulasta with the On-body Injector for Neulasta. There may be new information. This information does not take the place of talking with your healthcare provider about your medical condition or your treatment.

**What is the most important information I need to know about receiving Neulasta with the On-body Injector for Neulasta?**

- **See the Instructions for Use for the On-body Injector for Neulasta for detailed information about the On-body Injector for Neulasta and important information about your dose delivery that has been written by your healthcare provider.**
  - Know the time that delivery of your dose of Neulasta is expected to start.
  - Avoid traveling, driving, or operating heavy machinery during hour 26 through hour 29 after the On-body Injector for Neulasta is applied. Avoid activities and places that may interfere with monitoring during the **45-minute** period that Neulasta is expected to be delivered by the On-body Injector for Neulasta, and for 1 hour after delivery.
- A caregiver should be with you the first time that you receive Neulasta with the On-body Injector for Neulasta.
- **If you have an allergic reaction during the delivery of Neulasta, remove the On-body Injector for Neulasta by grabbing the edge of the adhesive pad and peeling off the On-body Injector for Neulasta. Get emergency medical help right away.**
- **You should only receive a dose of Neulasta on the day your healthcare provider tells you.**
- **You should not receive your dose of Neulasta any sooner than 24 hours after you finish receiving your chemotherapy.** The On-body Injector for Neulasta is programmed to deliver your dose about 27 hours after your healthcare provider places the On-body Injector for Neulasta on your skin.
- **Do not** expose the On-body Injector for Neulasta to the following because the On-body Injector for Neulasta may be damaged and you could be injured:
  - MRI
  - X-ray
  - CT-Scan
  - Ultrasound
  - Oxygen rich environments, such as hyperbaric chambers

- Avoid airport X-ray scans. Request a manual pat down instead. Use care during a manual pat down to help prevent the On-body Injector for Neulasta from being accidentally removed.
- **Keep the On-body Injector for Neulasta at least 4 inches away from electrical equipment such as cell phones, cordless telephones, microwaves and other common appliances.** If the On-body Injector for Neulasta is too close to electrical equipment, it may not work correctly and can lead to a missed or incomplete dose of Neulasta.
- The On-body Injector is for adult patients only.
- **Call your healthcare provider right away if the:**
  - On-body Injector for Neulasta comes off before or during a dose delivery. **Do not re-apply it.**
  - On-body Injector for Neulasta is leaking.
  - adhesive on your On-body Injector for Neulasta becomes noticeably wet (saturated) with fluid, or there is dripping. This may mean that Neulasta is leaking out of your On-body Injector for Neulasta. If this happens you may only receive some of your dose of Neulasta, or you may not receive a dose at all.
  - On-body Injector for Neulasta status light is flashing red.

### **What is Neulasta?**

Neulasta is a prescription medicine used to help reduce the chance of infection due to a low white blood cell count, in people with certain types of cancer (non-myeloid), who receive anti-cancer medicines (chemotherapy) that can cause fever and low blood cell count.

### **Who should not take Neulasta?**

**Do not** take Neulasta if you have had a serious allergic reaction to pegfilgrastim (Neulasta<sup>®</sup>) or to filgrastim (Neupogen<sup>®</sup>).

### **What should I tell my healthcare provider before receiving Neulasta?**

**Before you receive Neulasta, tell your healthcare provider if you:**

- have sickle cell trait or sickle cell disease
- have had severe skin reactions to acrylic adhesives
- are allergic to latex
- have problems with your kidneys
- have any other medical problems
- are pregnant or plan to become pregnant. It is not known if Neulasta may harm your unborn baby.

**Pregnancy Registry:** There is a pregnancy registry for women who become pregnant during treatment with Neulasta. The purpose of this registry is to collect information about the health of you and your baby. You are encouraged to enroll in this registry. Your healthcare provider may enroll you, or you may enroll by calling 1-800-AMGEN (1-800-772-6436).

- are breastfeeding or plan to breastfeed. It is not known if Neulasta passes into your breast milk.

Tell your healthcare provider about all the medicines you take, including prescription and over-the-counter medicines, vitamins, and herbal supplements.

### **How will I receive Neulasta?**

**See the Instructions for Use for detailed information about how you will receive a dose of Neulasta with the On-body Injector for Neulasta, and how to remove and dispose of the On-body Injector for Neulasta.**

- **See the section “What is the most important information I need to know about receiving Neulasta with the On-body Injector for Neulasta?”**
- Neulasta is given as an injection under the skin (subcutaneous). Your healthcare provider will use a prefilled syringe with Neulasta to fill the On-body Injector prior to applying it. The prefilled syringe with Neulasta and the On-body Injector are provided to your healthcare provider as part of Neulasta Onpro™ kit. The On-body Injector for Neulasta will be applied to the stomach area (abdomen) or back of your arm by your healthcare provider. If the On-body Injector for Neulasta was placed on the back of your arm, a caregiver must be available to monitor the On-body Injector for Neulasta.
- Your healthcare provider should place the On-body Injector for Neulasta on an area of your skin that does not have swelling, redness, cuts, wounds, or abrasions. Tell your healthcare provider about any skin reactions that happen in the On-body Injector for Neulasta application area after it has been applied.
- The On-body Injector for Neulasta is programmed to deliver your dose about 27 hours after your healthcare provider places the On-body Injector for Neulasta on your skin.
- The dose of Neulasta will be delivered over about 45 minutes. During dose delivery and for 1 hour after delivery, it is best to stay in a place where you or a caregiver can monitor the On-body Injector for Neulasta to make sure you receive your full dose of Neulasta and watch for symptoms of an allergic reaction.
- Keep the On-body Injector for Neulasta dry for about the last 3 hours before the dose delivery is expected to start. This will help you to better detect possible leaking from the On-body Injector for Neulasta.
- Only expose the On-body Injector for Neulasta to temperatures between 41°F to 104°F (5°C to 40°C).

### **What should I avoid while the On-body Injector for Neulasta is in place?**

**While the On-body Injector for Neulasta is in place you should avoid:**

- traveling, driving or operating heavy machinery during hour 26 through hour 29 after the On-body Injector for Neulasta is applied.

- sleeping on the On-body Injector for Neulasta or applying pressure on the On-body Injector for Neulasta. The On-body Injector for Neulasta may not work properly.
- bumping the On-body Injector for Neulasta or knocking it off your body.
- getting body lotion, creams, oils, and skin cleansing products near the On-body Injector for Neulasta. These products may loosen the adhesive that holds the On-body Injector for Neulasta onto your body.
- using hot tubs, whirlpools, or saunas, and direct sunlight. These may affect Neulasta.
- peeling off or disturbing the On-body Injector for Neulasta adhesive before you receive your full dose of Neulasta.

### **What are possible side effects of Neulasta?**

#### **Neulasta can cause serious side effects, including:**

- **Spleen rupture.** Your spleen may become enlarged or may rupture during treatment with Neulasta. A ruptured spleen can cause death. Call your healthcare provider right away if you have pain in your left upper stomach area or left shoulder area. This pain could mean your spleen is enlarged or ruptured.
- **A serious lung problem called Acute Respiratory Distress Syndrome (ARDS).** Call your healthcare provider or get emergency medical help right away if you get any of these symptoms of ARDS: fever, shortness of breath, trouble breathing, or a fast rate of breathing.
- **Serious allergic reactions.** Get emergency medical help right away if you get any of these symptoms of a serious allergic reaction with Neulasta: shortness of breath, wheezing, dizziness, swelling around the mouth or eyes, fast pulse, sweating, and hives.

**If you have an allergic reaction during the delivery of Neulasta, remove the On-body Injector for Neulasta by grabbing the edge of the adhesive pad and peeling off the On-body Injector for Neulasta. Get emergency medical help right away.**

- **Sickle cell crises.** Severe sickle cell crises, and sometimes death, can happen in people with sickle cell trait or disease who receive filgrastim, a medicine similar to Neulasta (pegfilgrastim).
- **Kidney injury (glomerulonephritis).** Kidney injury has been seen in patients who received Neulasta. You should notify your healthcare provider right away if you experience puffiness in your face or ankles, blood in your urine or brown colored urine or you notice you urinate less than usual.
- **Increased white blood cell count (leukocytosis).** Your doctor will check your blood during treatment with Neulasta.



- **Capillary Leak Syndrome.** Neulasta can cause fluid to leak from blood vessels into your body's tissues. This condition is called "Capillary Leak Syndrome" (CLS). CLS can quickly cause you to have symptoms that may become life-threatening. Get emergency medical help right away if you develop any of the following symptoms:
  - swelling or puffiness and are urinating less often
  - trouble breathing
  - swelling of your stomach-area (abdomen) and feeling of fullness
  - dizziness or feeling faint
  - a general feeling of tiredness

The most common side effect of Neulasta is pain in the bones and in your arms and legs.

Tell your healthcare provider if you have any side effect that bothers you or that does not go away.

These are not all the possible side effects of Neulasta. For more information, ask your healthcare provider or pharmacist.

Call your doctor for medical advice about side effects. You may report side effects to FDA at 1-800-FDA-1088.

### **General information about the safe and effective use of Neulasta**

Medicines are sometimes prescribed for purposes other than those listed in a Patient Information leaflet. If you would like more information about Neulasta, talk with your healthcare provider or pharmacist. You can ask your pharmacist for information about Neulasta that is written for health professionals.

For more information, go to [www.neulasta.com](http://www.neulasta.com) or call 1-844-696-3852 (1-844-MYNEULASTA).

### **What are the ingredients in Neulasta?**

Active ingredient: pegfilgrastim

Inactive ingredients: acetate, polysorbate 20, and sodium, sorbitol in Water for Injection.

This Patient Information has been approved by the U.S. Food and Drug Administration.



Neulasta® (pegfilgrastim)

**Manufactured by:**

Amgen Inc.  
One Amgen Center Drive  
Thousand Oaks, California 91320-1799  
US License No. 1080

Patent: <http://pat.amgen.com/neulasta/>

© 2002 to 2015 Amgen Inc. All rights reserved.

[www.neulasta.com](http://www.neulasta.com)

1-844-MYNEULASTA (1-844-696-3852)

Issued: 11/2015

vX

**Neulasta®**

**Pegfilgrastim**

### **Information for Patients and Caregivers**

This patient package insert provides information and instructions for people who will be receiving Neulasta or their caregivers. This patient package insert does not tell you everything about Neulasta. You should discuss any questions you have about treatment with Neulasta with your doctor.

#### **What is Neulasta?**

Neulasta is a man-made form of granulocyte colony-stimulating factor (G-CSF), which is made using the bacteria *Escherichia coli*. G-CSF is a substance produced by the body. It stimulates the growth of neutrophils (**nu**-tro-fils), a type of white blood cell important in the body's fight against infection.

#### **Who should not take Neulasta?**

Do not take Neulasta if you have had:

- A serious allergic reaction to Neulasta® (pegfilgrastim) or to Neupogen® (filgrastim).

#### **What important information do I need to know about receiving Neulasta?**

Occasionally, pain and redness may occur at the injection site. If there is a lump, swelling, or bruising at the injection site that does not go away, talk to the doctor.

Neulasta should only be injected on the day the doctor has determined and should not be injected until approximately 24 hours after receiving chemotherapy.

If your child weighs less than 45 kg, do not use the prefilled syringe for direct administration of Neulasta. The Neulasta prefilled syringe is not designed to allow for direct administration of doses less than 6 mg.

The needle cover on the single-use prefilled syringe contains dry natural rubber (latex), which should not be handled by persons sensitive to this substance.

#### **What should I tell my healthcare provider before taking Neulasta?**

If you have a sickle cell disorder, make sure that your doctor knows about it before you start using Neulasta. If you have a sickle cell crisis after getting Neulasta, tell your doctor right away.

If you have a problem with your kidneys, make sure that your doctor knows about it before you start using Neulasta as you may need more frequent urine tests.

If you have any questions, talk to your doctor.

#### **Why am I given Neulasta if I was exposed to radiation?**

Exposure to high levels of radiation damages bone marrow. Damage to the bone marrow can be deadly. Neulasta increases your chance of survival.

Effectiveness of Neulasta in increasing survival after radiation exposure was only studied in animals. Neulasta given after deadly radiation levels could not be studied in people.

#### **What are possible serious side effects of Neulasta?**

- **Spleen Rupture.** Your spleen may become enlarged and can rupture while taking Neulasta. A ruptured spleen can cause death. The spleen is located in the upper left section of your stomach area. Call your doctor right away if you have pain in the left upper stomach area or left shoulder tip area. This pain could mean your spleen is enlarged or ruptured.
- **A serious lung problem called Acute Respiratory Distress Syndrome (ARDS).** Call your doctor or seek emergency care right away if you have shortness of breath, trouble breathing, or a fast rate of breathing.
- **Serious Allergic Reactions.** Neulasta can cause serious allergic reactions. These reactions can cause shortness of breath, wheezing, dizziness, swelling around the mouth or eyes, fast pulse, sweating, and hives. If you start to have any of these symptoms, call your doctor or seek emergency care right away. If you have an allergic reaction during the injection of Neulasta, stop the injection. Call your doctor right away.
- **Sickle Cell Crises.** You may have a serious sickle cell crisis if you have a sickle cell disorder and take Neulasta. Serious and sometimes fatal sickle cell crises can occur in patients with sickle cell disorders receiving filgrastim, a medicine similar to Neulasta (pegfilgrastim). Call your doctor right away if you have symptoms of sickle cell crisis such as pain or difficulty breathing.
- **Kidney injury (glomerulonephritis).** Kidney injury has been seen in patients who received Neulasta. Call your doctor right away if you experience puffiness in your face or ankles, blood in your urine or brown colored urine or you notice you urinate less than usual.
- **Increased white blood cell count (leukocytosis).** Your doctor will check your blood during treatment with Neulasta.
- **Capillary Leak Syndrome.** Neulasta can cause fluid to leak from blood vessels into your body's tissues. This condition is called "Capillary Leak Syndrome" (CLS). CLS can quickly cause you to have symptoms that may become life-threatening. Get emergency medical help right away if you develop any of the following symptoms:
  - swelling or puffiness and are urinating less often
  - trouble breathing
  - swelling of your stomach-area (abdomen) and feeling of fullness
  - dizziness or feeling faint
  - a general feeling of tiredness

**What are the most common side effects of Neulasta?**

The most common side effect you may experience is aching in the bones and muscles. If this happens, it can usually be relieved with a non-aspirin pain reliever, such as acetaminophen.

**What about pregnancy or breastfeeding?**

Neulasta has not been studied in pregnant women, and its effects on unborn babies are not known. If you take Neulasta while you are pregnant, it is possible that small amounts of it may get into your baby's blood. It is not known if Neulasta can get into human breast milk. If you are pregnant, plan to become pregnant, think you may be pregnant, or are breastfeeding, you should tell your doctor before using Neulasta. If you become pregnant during Neulasta treatment, you are encouraged to enroll in Amgen's Pregnancy Surveillance Program. You should call 1-800-77-AMGEN (1-800-772-6436) to enroll.

**HOW TO PREPARE AND GIVE A NEULASTA INJECTION**

**If your child weighs less than 45 kg, do not use the prefilled syringe for direct administration of Neulasta. The Neulasta prefilled syringe is not designed to allow for direct administration of doses less than 6 mg.**

Neulasta is provided in a prefilled syringe. **Neulasta should be stored in its carton to protect from light until use.** If you are giving someone else Neulasta injections, it is important that you know how to inject Neulasta. Before getting your Neulasta injection, always check to see that:

- The name Neulasta appears on the carton and prefilled syringe label.
- The expiration date on the prefilled syringe has not passed. **You should not use a prefilled syringe after the date on the label.**
- The Neulasta liquid should always be clear and colorless. Do not use Neulasta if the contents of the prefilled syringe appear discolored or cloudy, or if the prefilled syringe appears to contain lumps, flakes, or particles.

**IMPORTANT: TO HELP AVOID POSSIBLE INFECTION, YOU SHOULD FOLLOW THESE INSTRUCTIONS.**

**Setting up for an injection**

**Note: The needle cover on the single-use prefilled syringe contains dry natural rubber (latex), which should not be handled by persons sensitive to this substance.**

1. Find a clean, flat working surface, such as a table.
2. Remove the carton containing the prefilled syringe of Neulasta from the refrigerator. Allow Neulasta to reach room temperature (this takes about 30 minutes). Remove the syringe from the carton before injection. Each prefilled syringe should be used only once. **DO NOT SHAKE THE PREFILLED SYRINGE.** Shaking may damage Neulasta. If the prefilled syringe has been shaken vigorously, the solution may appear foamy and it should not be used.
3. Assemble the supplies you will need for an injection:
  - Neulasta prefilled syringe with transparent (clear) plastic blue needle guard attached

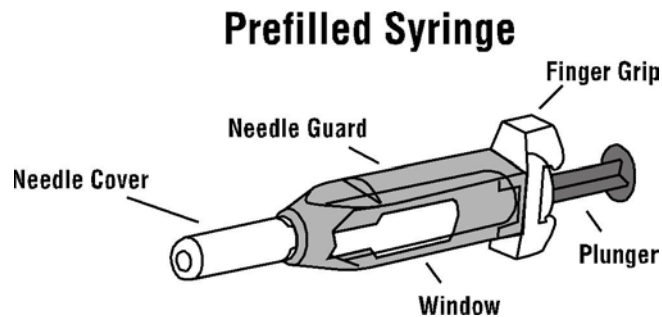

- An alcohol swab and a cotton ball or gauze

**Alcohol Swab**



**Cotton Ball**



- Puncture-proof disposal container

4. Wash your hands with soap and warm water.



### **HOW TO PREPARE FOR INJECTION OF NEULASTA**

5. Remove the prefilled syringe from the package and the tray. Check to see that the plastic blue needle guard is covering the barrel of the glass syringe. **DO NOT** push the blue needle guard over the needle cover before injection. This may activate or lock the needle guard. If the blue needle guard is covering the needle that means it has been activated. **DO NOT** use that syringe. Dispose of that syringe in the puncture-proof disposal container. Use a new prefilled syringe. **Do not activate the needle guard prior to injection.**
6. Hold the syringe barrel through the needle guard windows with the needle pointing up. Holding the syringe with the needle pointing up helps to prevent medicine from leaking out of the needle. Carefully pull the needle cover straight off.
7. Check the syringe for air bubbles. If there are air bubbles, gently tap the syringe with your fingers until the air bubbles rise to the top of the syringe. Slowly push the plunger up to force the air bubbles out of the syringe.
8. Gently place the prefilled syringe with the window flat on your clean working surface so that the needle does not touch anything.

### **Selecting and preparing the injection site**

9. Choose an injection site. Four recommended injection sites for Neulasta are:
  - The outer area of the upper arms
  - The abdomen, except for the two-inch area around the navel
  - The front of the middle thighs
  - The upper outer areas of the buttocks

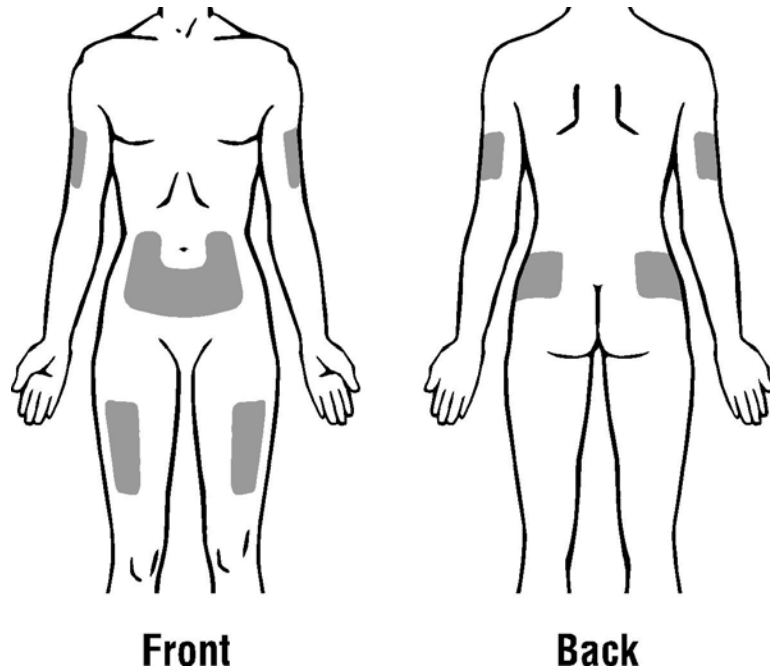

10. Clean the injection site with an alcohol swab.

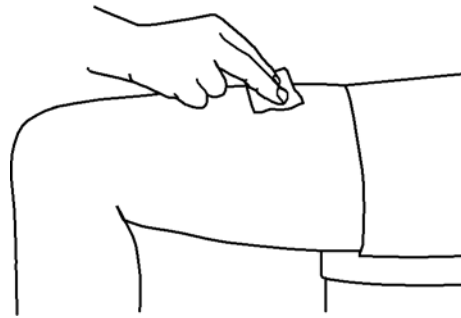

### **Injecting the dose of Neulasta**

11. Pick up the prefilled syringe from your clean, flat working surface by grabbing the sides of the needle guard with your thumb and forefinger.
12. Hold the syringe in the hand you will use to inject Neulasta. Use the other hand to pinch a fold of skin at the cleaned injection site. Note: Hold the syringe barrel through the needle guard windows when giving the injection.

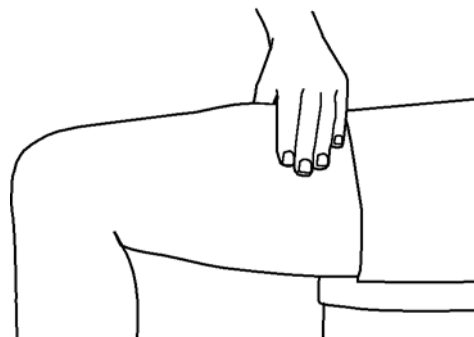

13. Holding the syringe like a pencil, use a quick “dart-like” motion to insert the needle either straight up and down (90 degree angle) or at a slight angle (45 degrees) into the skin.

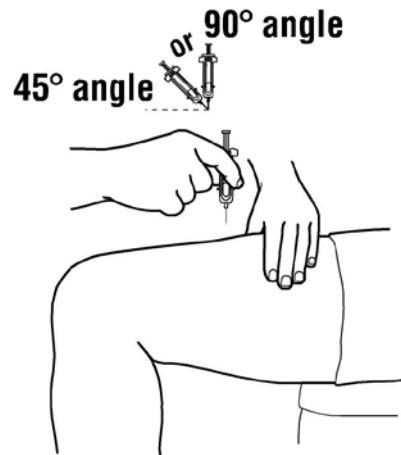

14. Inject the prescribed dose subcutaneously as directed by your doctor, nurse, or pharmacist.

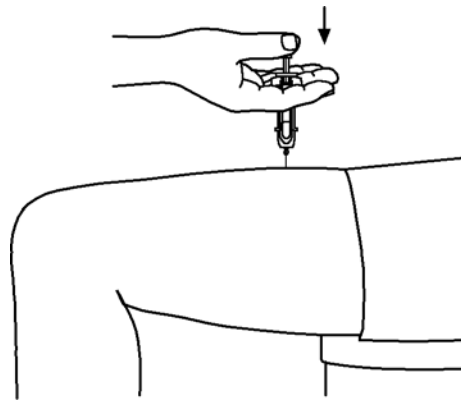

15. When the syringe is empty, pull the needle out of the skin and place a cotton ball or gauze over the injection site and press for several seconds.

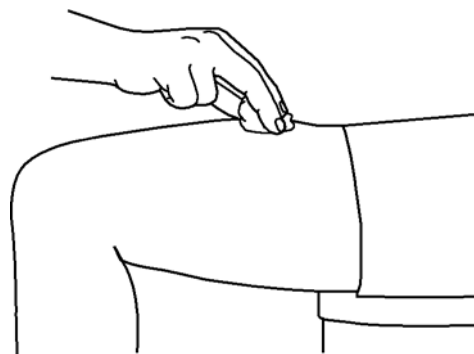

16. Use a prefilled syringe with the needle guard only once.

**Activating the Needle Guard after the injection has been given**



17. After injecting Neulasta from the prefilled syringe, do not recap the needle. Keep your hands behind the needle at all times. While holding the clear plastic finger grip of the syringe with one hand, grasp the blue needle guard with your free hand and slide the blue needle guard over the needle until the needle is completely covered and the needle guard clicks into place. **NOTE: If an audible click is not heard, the needle guard may not be completely activated.**

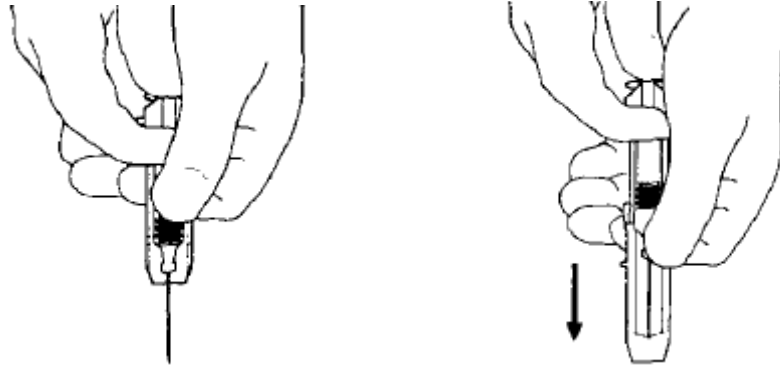

18. Place the prefilled syringe with the activated needle guard into a puncture-proof container for proper disposal as described below.

#### **Disposal of prefilled syringes and needle guards**

You should always follow the instructions given by your doctor, nurse, or pharmacist on how to properly dispose of containers with used syringes and needle guards. There may be special state and local laws for disposal of used needles and syringes.

- Do not throw the container in the household trash. Do not recycle.
- DO NOT put the needle cover (the cap) back on the needle.
- Place all used needle covers and syringes in a hard plastic container with a screw-on cap or in a metal container with a plastic lid such as a coffee can labeled “used syringes.” If a metal container is used, cut a small hole in the plastic lid and tape the lid to the metal container. If a hard plastic container is used, always screw the cap on tightly after each use.
- Do not use glass or clear plastic containers.
- When the container is full, tape around the cap or lid to make sure the cap or lid does not come off.
- **Always** keep the container out of the reach of children.

#### **How should Neulasta be stored?**

Neulasta should be stored in the refrigerator at 2° to 8°C (36° to 46°F), but not in the freezer. Neulasta should be protected from light, so you should keep it in its carton until you are ready to use it. Avoid shaking Neulasta. If Neulasta is accidentally frozen, allow it to thaw in the refrigerator before injecting. However, if it is frozen a second time, do not use. Neulasta can be left out at room temperature for up to 48 hours. Do not leave Neulasta in direct sunlight. For all questions about storage, contact your doctor, nurse, or pharmacist.

#### **What are the ingredients in Neulasta?**

Each syringe contains pegfilgrastim in a sterile, clear, colorless, preservative-free solution containing acetate, sorbitol, polysorbate 20, and sodium.

**AMGEN**<sup>®</sup>

Neulasta<sup>®</sup> (pegfilgrastim)

**Manufactured by:**

Amgen Inc.  
One Amgen Center Drive  
Thousand Oaks, California 91320-1799

Patent: <http://pat.amgen.com/neulasta/>

©2002- 2015 Amgen Inc. All rights reserved.

[www.neulasta.com](http://www.neulasta.com)

1-800-77-AMGEN (1-800-772-6436)

Revised: 11/2015

1xxxxx

v 1X