

RRC 111920

This home collection kit has not been FDA cleared or approved.

This home collection kit has been authorized by FDA under an EUA for use by authorized laboratories.

This home collection kit has been authorized only for the home collection and maintenance of nasal swab specimens as an aid in detection of nucleic acid from SARS-CoV-2, not for any other viruses or pathogens.

This home collection kit in combination with the authorized test is only authorized for the duration of the declaration that circumstances exist justifying the authorization of emergency use of medical devices for detection and/or diagnosis of COVID-19 under Section 564(b)(1) of the Federal Food, Drug and Cosmetic Act, 21 U.S.C. § 360bbb3(b)(1), unless the authorization is terminated or revoked sooner.



Rx only. For use under Emergency Use Authorization (EUA) only.

Distributed by RapidRona Inc. www.rapidrona.com 11/2020

If you have questions during your specimen collection, please contact help@rapidrona.com



Self-Collection Kit

INSTRUCTIONS FOR USE

TEST KIT CONTENTS



Sample swab



Tube label



Collection tube



Saline pack



Biohazard bag

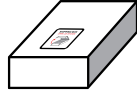

Lab sample box

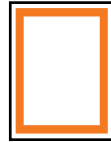

Shipping envelope

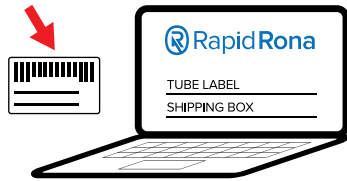

- 1** Log in and register your test kit online. Go to www.rapidrona.com/instructions and enter the numbers from the tube and lab sample box labels.

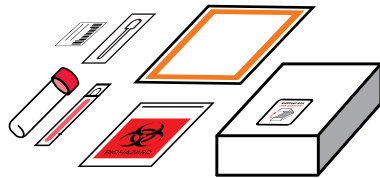

- 3** Place kit contents on a clean, dry surface with enough room to collect your sample.

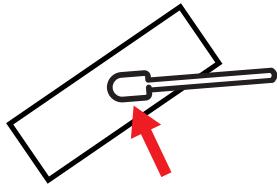

- 5** Remove sample swab from its packaging. Do not touch the tip and do not set the swab down.



- 2** Wash your hands for at least 20 seconds and dry.

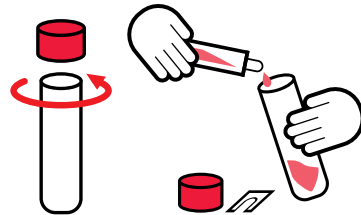

- 4** Open collection tube and empty saline pack into tube. Do not spill or drink liquid. Do not add any other liquid. It is okay to cap the tube and set it down.



- 6** Insert tip of sample swab into one nostril. Insert tip just until it can't be seen (not too far, about half an inch). Rotate swab against the inside edge of your nostril 3 times.

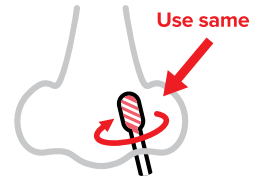

- 7** Repeat step 6 in your other nostril, using the same tip.



- 8** Wash your hands for at least 20 seconds and dry.

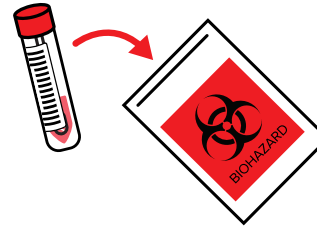

- 9** Place tube into biohazard bag with absorbent pad. Seal the bag.

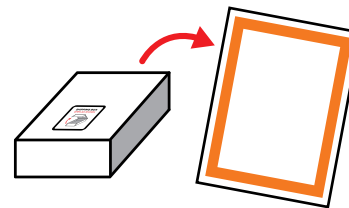

- 13** Place lab sample box into shipping envelope and seal.



- 10** Place sample swab in tube, sample end into the liquid. Screw cap back on.

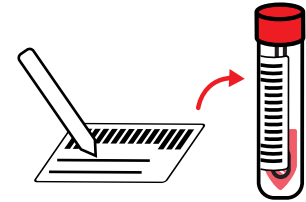

- 11** Using a pen, write your name and date of birth on tube label. Peel off the sticker back and place the label length-wise on the tube.

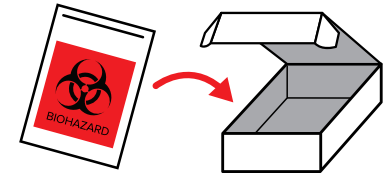

- 12** Place biohazard bag into lab sample box and insert tabs to seal box.



- 14** Return to computer to schedule package pickup (you may need to log in again). Go to www.rapidrona.com/instructions