

3M 9001

Particulate Respirator

Standard Size / Earloop

User Instructions

IMPORTANT: Keep these User Instructions for reference

GB2626-2006 KN90



⚠ WARNING

This respirator helps protect against certain particles. **Misuse can result in sickness or death.** For proper use, see supervisor or User Instructions on package or call 3M, 400-920-3595. For US, call 1-800-243-4630.

IMPORTANT

Before use, the wearer must read and understand these User Instructions. Keep these instructions for reference. See information supplied by the manufacturer.

Use For

Mechanically generated dusts, non-oil mists from processing minerals including coal, iron ore, wood, cotton, flour and certain other substances in concentrations up to ten times the Occupational Exposure Limits or according to local regulations.

Do Not Use For

Paint spraying and sandblasting applications or for protection against gases and vapors. Do not use in atmospheres containing less than 19.5% oxygen, as this respirator does not supply oxygen. Not for use in oil mist atmospheres.

Use Limitations and Warnings

1. The wearer must first be trained in the proper use and fit tested before using this respirator.
2. Do not use this respirator when concentrations of contaminants are immediately dangerous to life or health.
3. Leave the contaminated area immediately if breathing becomes difficult, or dizziness or other distress occurs.
4. Discard and replace respirator if it becomes damaged or breathing resistance becomes excessive.

5. Inspect respirator before each use to ensure it is in good working condition. Examine all the respirator parts for signs of damage including the two straps, noseclip and staples.
6. Do not alter, wash, abuse or misuse this respirator.
7. Do not use with beards or other facial hair or other conditions that prevent a good seal between the face and the sealing edge of the respirator.
8. Can be used up to the limits specified by applicable government regulations for this product.
9. Failure to follow all instructions and warnings on the use of this respirator and/or failure to wear this respirator during all times of exposure can reduce respirator effectiveness and **may result in illness or permanent disability.**
10. Make sure the respirator is not crushed or squeezed by an outside force, as this may result in the deformation and damage of the respirator. Especially pay more attention when the wearer is biking, running or conducting other activities.
11. Outside forces acting upon the noseclip or staple on the respirator may result in injury to the wearer.

Storage Conditions and Shelf Life

Shelf life of unopened product is 5 years from date of manufacture when stored within temperature range of -20°C to $+30^{\circ}\text{C}$ and at less than 80% relative humidity.

This respirator contains no components made from natural rubber latex.



Shelf life of unopened product is 5 years from date of manufacture.



Temperature Range: -20°C to $+30^{\circ}\text{C}$



Maximum Relative Humidity: $<80\%$

$<80\%$

This respirator contains no components made from natural rubber latex.

Fitting Instructions

Must be followed each time respirator is worn.

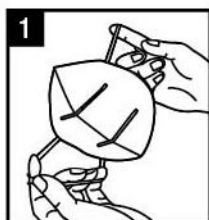

1. With nosepiece facing away from you, hold the earloop strap in each hand with the nosepiece up.
2. Position the respirator under the chin.
3. Pull each strap over the ear. Adjust the straps as comfortable as possible.
4. Place the fingertips of both hands at the top of the metal nosepiece. Mold the nosepiece to the shape of the nose bridge by pushing inwards while moving your fingertips down both sides of the nosepiece. Pinching the respirator nosepiece using only one hand may result in less effective respirator fit.
5. The seal of the respirator on the face should be checked by the wearer prior to entering the work area.
 - a) Cover the front of the respirator with both hands, being careful not to disturb the position of the respirator.
 - b) Exhale sharply. If air leaks around the nose bridge, readjust the nosepiece as described in step 4. If air leaks at the respirator edges, work the straps back along the side of your hand. If you CANNOT achieve a proper seal, DO NOT enter the contaminated area. See your supervisor.
 - c) If no leakage is detected, then work may proceed.

It is very important to press the nosepiece firmly to the nose bridge to form a good seal.

**3M China Co. Ltd
222 Tianlin Road
Shanghai China 200233
Tel: 86-21-2210 5335
Fax: 86-21-2210 5035
Website : <http://www.3M.com.cn/PPE>
Made in China
© 3M 2018. All rights reserved.
3M is a trademark of 3M Company.**